



**CHHATTISGARH STATE MINOR FOREST PRODUCE
(Trading & Development) CO-OPERATIVE FEDERATION LIMITED**

TENDER DOCUMENT (ROUND 3)

Tender for Supply, Installation, Testing, Commissioning, Integration and Training of following processing machines at Incubation Center Deobhog, District-Gariyaband (C.G.)

| Code | Processing Units |
|------|--|
| 101 | Chironjee Processing Unit |
| 102 | Neem/Mahua/Kusum/Groundnut Oil Processing and Chikki Making Unit |
| 103 | Masala Processing Unit |
| 104 | Primary Processing Unit |
| 105 | Lac Processing Unit |
| 106 | Pulse Milling Unit |

Part A. PAC– Rs. 171 LAKH

Part B. PAC– Rs. 15 LAKH

Total PAC– Rs. 186 LAKH

NIT No. Fed/Processing Machines/2023-24/III

Dated:13.12.23

Issued by:

MANAGING DIRECTOR

**CHHATTISGARH MINOR FOREST PRODUCE (T&D)
CO-OPERATIVE FEDERATION LIMITED**

"Van Dhan Bhawan", Sector - 24, Nava Raipur Atal Nagar,

Tel: 0771-2513100 - 110

E-mail: mfpfed.cg@nic.in Website: www.cgmfpfed.org

TABLE OF CONTENTS

| | |
|--|-----------|
| SECTION-I : NOTICE INVITING TENDER..... | 03 |
| SECTION-II : INSTRUCTIONS FOR THE SUBMISSION OF THE ONLINE TENDER | 11 |
| SECTION-III : SPECIAL CONDITIONS OF CONTRACT..... | 17 |
| SECTION-IV: SCOPE OF WORK..... | 23 |
| SECTION-V: TECHNICAL SPECIFICATIONS..... | 25 |
| SECTION-VI: TECHNICAL BID FORMAT..... | 30 |
| SECTION-VII: FINANCIAL BID FORMAT..... | 37 |

**CHHATTISGARH STATE MINOR FOREST PRODUCE
(TRADING & DEVELOPMENT) CO-OP. FEDERATION LIMITED**

" Van Dhan Bhawan " Sector -24, Nava Raipur Atal Nagar (Chhattisgarh)

Pin code – 492001, Phoned: (0771) 2513100 to 2513110

E-mail: mfpfed.cg@nic.in Website: www.cgmfpfed.org

Notification No. Fed/Processing Machines/2023-24/III

Dated:13.12.23

SECTION-I: NOTICE INVITING TENDER (ROUND 3)

Online tenders are invited on e-procurement portal <https://cgmfpfedtenders.abcprocure.com> for Supply, Installation, Testing, Commissioning, Integration and Training of following processing machines at Incubation Center Deobhog, District-Gariyaband (C.G.).

| Code | Processing Units | Code | Processing Units |
|------|--|------|-------------------------|
| 101 | Chironjee Processing Unit | 104 | Primary Processing Unit |
| 102 | Neem/Mahua/Kusum/Groundnut Oil Processing and Chikki Making Unit | 105 | Lac Processing Unit |
| 103 | Masala Processing Unit | 106 | Pulse Milling Unit |

The Bidder can download the tender Document from our website www.cgmfpfed.org and e-Procurement portal <https://cgmfpfedtenders.abcprocure.com>

1. The detailed NIT is as under: -

Table No. 1: Key Information

| | |
|---|---|
| i) Cost of Tender Document* | Rs. 3540/- (including GST @18%) payment though online mode only on our e-procurement portal https://cgmfpfedtenders.abcprocure.com |
| ii) Earnest Money Deposit (EMD)* | Rs. 3,00,000/- payment though online mode only on our e-procurement portal https://cgmfpfedtenders.abcprocure.com |
| *The Bidder will have to make the online payment in combined mode only (Cost of Tender Document and EMD amount i.e., Rs 3540+ Rs 3,00,000 = Rs. 3,03,540). Cost of Tender Document is not refundable. If Bidder fails to meet the eligibility criteria (Technical or Financial) in that case the EMD Cost of Rs. 3,00,000/- only will be refunded). | |
| iii) Part A- Processing Machine (Including training charges for the period of six months starting from the date of completion of trial run) | |
| a) Delivery Schedule for Supply, Installation, Testing, Commissioning and Integration | |
| 101 - Chironjee Processing Unit | 120 Days from the date of issue of Work order |
| 102 - Neem/Mahua/Kusum/Groundnut Oil Processing and Chikki Making Unit | (Progressive supply of Machines/Equipment should commence from 60 days onwards, from the date of issue of work order). |
| 103 - Masala Processing Unit | |
| 104 - Primary Processing Unit | |
| 105 - Lac Processing Unit | |
| 106 - Pulse Milling Unit | |
| iii) Part B: Engagement of Technical Human Resource(s) from the Bidders (As required): Providing Technical Human Resource for O&M/ Training/Skill Development of staff engaged in the processing unit as per requirement | |

| | | | | |
|---|--|---|---------------------------------------|---------------------------------------|
| TRAINING & Skill Enhancement for O&M of the Processing Machines/ Equipment | | Period for which this service category may be availed by Federation will commence after the completion of vendors contractual obligation for mandatory training as per clause 31.1 of Section II “Special Condition of Contract “, as per the tender document. This service shall be availed as per requirement of Federation | | |
| Key Dates | | | | |
| Tender Round | Date from which e-Bid notice can be downloaded | Starting date of online submission of Bid | Last date of online submission of Bid | Date of online opening of Bid |
| First | 15.12.2023 | 28.12.2023 From 11:00 AM | 12.01.2024 Up to 3:00 PM | 12.01.2024 3:30 PM onwards |
| Second | 19.01.2024 | 24.01.2024 From 11:00 AM | 02.02.2024 Up to 3:00 PM | 02.02.2024 3:30 PM onwards |
| Third | 06.02.2024 | 08.02.2024 From 11:00 AM | 13.02.2024 Up to 3:00 PM | 13.02.2024 3:30 PM onwards |

- Bids are to be submitted online in the prescribed Tender Forms in two parts, Technical and Financial Bid.
- The eligible bidder will have to submit bids for all the machines/equipment as mentioned under each Code and sub code group. Bids must be submitted for all the machines listed under code 101 to 106. Part bidding will not be accepted, and such proposals shall be summarily rejected. The detailed list of Processing machines, required quantity, estimated PAC value and EMD is mentioned in the Table No 2 below-

Table No. 2 – Detailed Information of Processing Machine

| Group Code | Processing Machines | Qty (in Nos.) | PAC Estimate (INR) | EMD (INR) |
|------------|--|---------------|--------------------|-------------------|
| 101 | Chironjee Processing Unit Machine | | 22,50,000/- | 3,00,000/- |
| 10101 | Double shelling machine | 2 | | |
| 10102 | Chalna Double Compartment | 1 | | |
| 10103 | Chironjee Dana Separator | 1 | | |
| 10104 | Dryer Machine | 1 | | |
| 10105 | Air aspirator with cyclone dust collector | 1 | | |
| 10106 | Vacuum packaging machine with nitrogen flushing | 1 | | |
| 10107 | Weighing Machine | 1 | | |
| 102 | Neem/Mahua/Kusum/Groundnut Oil Processing and Chikki Making Unit- | | 41,75,000/- | |
| 10201 | Oil expeller | 3 | | |
| 10202 | Round automatic feeding + cooking kettle with steam jacket | 2 | | |
| 10203 | Long automatic feeding + cooking kettle with steam jacket | 1 | | |
| 10204 | Filter press 16" X 16" - 16plate complete | 2 | | |

| | | | | |
|---|--|---|----------------------|--|
| 10205 | Centrifugal oil separator | 1 | | |
| 10206 | Seed decorticator | 2 | | |
| 10207 | Electric motor 12.5 hp | 3 | | |
| 10208 | Conveyor complete | 3 | | |
| 10209 | Grinding / hammer mill / multipurpose pulveriser | 1 | | |
| 10210 | Oil tank | 1 | | |
| 10211 | Extra filter pump with 1.5 hp | 1 | | |
| 10212 | Strong table | 2 | | |
| 10213 | Electric boiler complete | 1 | | |
| 10214 | Bottle filling machine | 2 | | |
| 10215 | Ground nut roasting machine | 1 | | |
| 10216 | Ground nut tasta remover | 1 | | |
| 10217 | Concentrator cum mixing tank | 1 | | |
| 10218 | Moulding frame hydraulic press | 1 | | |
| 103 | Masala Processing Unit- | | 53,75,000/- | |
| 10301 | Hammer Mill | 1 | | |
| 10302 | Air Lock | 1 | | |
| 10303 | Shifter Machine | 1 | | |
| 10304 | Pulveriser | 1 | | |
| 10305 | Cabinet Dryer | 1 | | |
| 10306 | Band Sealer machine | 1 | | |
| 10307 | Grader Machine | 1 | | |
| 10308 | Auger Filter Packing Machine | 1 | | |
| 10309 | Destoner | 1 | | |
| 10310 | Masala Washer Machine | 1 | | |
| D | Primary Processing Unit- | | 23,00,000/- | |
| 10401 | Vertical Bucket Elevation | 4 | | |
| 10402 | Grader (3 Compartment) | 1 | | |
| 10403 | Destoner | 1 | | |
| 10404 | Weighing Machine | 1 | | |
| 10405 | Colour Sorter with Compressor | 1 | | |
| E | Lac Processing Unit- | | 17,10,000/- | |
| 10501 | Lac Crusher Machine | 1 | | |
| 10502 | Lac Washer Machine | 1 | | |
| 10503 | Lac Chalna | 1 | | |
| 10504 | Lac Winnower | 1 | | |
| 10505 | Lac Destoner | 1 | | |
| 10506 | Lac Round Chalna | 1 | | |
| 10507 | Sesparator (Single Compartment) | 1 | | |
| 10508 | Lac Scraper | 1 | | |
| 10509 | Basket Centrifugal (SS) | 1 | | |
| 106 | Pulse Milling Unit- | | 13,10,000/- | |
| 10601 | Mini Dall Mill | 2 | | |
| 10602 | Double Screw Polisher | 1 | | |
| 10603 | Grader | 1 | | |
| 10604 | Dryer | 1 | | |
| 10605 | Buff Polisher | 1 | | |
| 10606 | Packaging Machine | 1 | | |
| 10607 | Weighing Machine | 1 | | |
| 10608 | Holding Bin | 1 | | |
| TRAINING (SIX MONTH) from the date of Trial run completion | | | | |
| | TOTAL | | 1,71,20,000/- | |

| | | | | |
|--|--|--|------------------------------|--|
| | | | Rounded: 171 Lakh | |
|--|--|--|------------------------------|--|

4. **Pre-Bid Meeting-** Deleted

5. (i) Online Tenders are to be submitted in the prescribed Forms only for **Technical Bid Format (Section-VI) and Financial Bid Format (Section- VII)**.

(ii) The Financial bid **should be all inclusive of machine cost plus G.S.T and Other Taxes as applicable on F.O.R** destination basis and cost per Manmonth towards Engagement of Technical Human Resource(s) for O&M/ Training/Skill Development of Incubation Center staff.

6. The Bidder may participate in the tender according to his capacity for Supply, Installation, Testing, Commissioning and Integration of following processing machines.

| Code | Machine for Processing Units | Code | Machine for Processing Units |
|------|--|------|------------------------------|
| 101 | Chironjee Processing | 104 | Primary Processing |
| 102 | Neem/Mahua/Kusum/Groundnut Oil Processing and Chikki Making- | 105 | Lac Processing |
| 103 | Masala Processing | 106 | Pulse Milling |

7. The Bidder shall submit Tender in separate envelop marked Technical and Financial Tender respectively as per Section-II (Instruction to Bidders)
8. The bidder should upload certified photocopies of all the documents required in this tender notice.
9. Decision of the Managing Director of the Federation shall be full, final, and binding on the bidder regarding their found eligible for evaluation of their bid with intimation shall be conveyed to the bidders by e-mail/letter.
10. Financial Tender of only those bidders who qualify in their Technical Tender shall be opened.
11. The financial evaluation of the bids submitted will be done for all the processing machines in the respective code group as listed in Clause-3 above. Following methodology shall be adopted to arrive at L1 Rate: Total amount provided under A) Cost of Processing Machine quoted by each bidder shall be assigned 95% weightage and, Manmonth cost provided under B) Engagement of Technical Human Resource(s) Cost shall be assigned 5% weightage. The Financial tender will be considered (L1) based on the methodology mentioned above, and the bidder quoting L1 will be awarded the work.
12. **Earnest Money Deposit (EMD):** The bidder will have to make the online payment of EMD as specified in Clause 1 point (ii) of the tender notice. The tender/s will summarily be rejected if there is any discrepancy in the amount of EMD that is required to be deposited as mentioned in Clause 1 point (ii) of the NIT. EMD must be deposited through payment gateway service provider in any of the following ways -

- A. **Credit Card / Debit Card (VISA / Master / Maestro Cards)** - The bidder after selecting the option of the Credit Card / Debit Card (VISA / Master / Maestro Cards) make the online payment, as per the instructions of payment mentioned in the payment gateway.
- B. **Net Banking** - Bidder can make the payment only from the bank account in having net banking facility. The list of banks for net banking will appear in the payment gateway and bidder should select his bank from that list and make the payment as per the instructions given in the payment gateway.

- C. **RTGS / NEFT** - The bidder can make the payment as per the instructions of clause 2.2 of enclosed **SECTION-II**.

The EMD of successful bidder shall be adjusted in the performance security or shall be refunded after receiving the Performance security as specified in the Tender document.

The E.M.D. of unsuccessful bidders will be returned online only in their Bank Account mentioned in the point no. 12 of Form No. 1 **Section-VI** only. No interest on E.M.D. will be paid under any circumstances.

13. The Bidder should keep validity of their Financial bid for 120 days from the date of opening of the Financial bid but not later than 150 days of opening of the Technical Tender.

14. Rate should be clearly mentioned in the Financial Tender in figures only.

15. Eligibility Criteria

15.1 TECHNICAL CRITERIA

- i. The bidder should be Equipment Manufacturer or Authorised Dealer or Project Integrator for the machines used for food processing/agro processing/oil extraction/food grain milling/fruit products/juice extraction/herbal extraction plant/ Lac processing unit. **(Suitable Proof of Equipment Manufacturer/Authorised Dealer/Project Integrator must be submitted with the Envelop for Technical Bid)**
- ii. The Bidder should have supplied, installed, and commissioned similar machine(s)/ equipment (i.e., supply, installation, Testing and Commissioning of food processing/agro processing/oil extraction/food grain milling/fruit products/juice extraction/herbal extraction plant/ lac processing unit) for the Govt./PSU/Company/ Partnership Firm/Proprietorship/LLP etc., **with minimum value of work of INR 50 lakh during the last three years through a single contract or multiple contracts. (Work order/purchase order /supply and commissioning certificate issued from the client (Govt./PSU/Company/ Partnership Firm/Proprietorship/LLP etc.) should be submitted by the bidder along with Technical Tender)**
- iii. The bidder must declare status of their bid as Manufacturer/Authorised Dealer/Project Integrator in the format set forth in **Section VI (Form 6) and Authorisation format set is forth in Section VI (Form 7)**
- iv. The bidder must submit **Non-Black List self-Declaration** stating that their firm has not been blacklisted by any Government Organization. Declaration should be signed only by the authorized official of the bidder on the letter head of the bidding firm.

15.2 FINANCIAL CRITERIA

Average Annual Turnover: The Bidder should have average annual turnover of Rs. 100 lakhs during the last three financial years (i.e., 2020-21, 2021-22 & 2022-23). **(CA certified Financial statement and annual turnover having UDIN must be uploaded).**

Supporting documents required to be submitted

| S.no | Required documents |
|------|--|
| 1 | Companies Pan Card |
| 2 | Companies GST registration certificate |
| 3 | Aadhaar Card issued by UIDAI of Managing Director of the Company and in case of Partnership firm Aadhaar Card of at least two of Partners |
| 4 | In case of Hindu Undivided Family (HUF) Aadhaar Card of Karta and one adult family member |
| 5 | Registration certificate of the company |
| 6 | Undertaking and letter of Acceptance as set forth in FORM 3 (on 100 Rs. Non-Judicial Stamp Paper) |
| 7 | Documents in support of Technical Capacity 15.1 (ii) as set forth in FORM 4 of Tender document |
| 8 | CA certified bidder's Turnover Certificate (having UDIN) for FY 2020-21, 2021-22 & 2022-23, as per clause 15.2 of the Tender Notice |
| 9 | Income tax return for FY 2020-21, 2021-22 and 2022-23 |
| 10 | CA certified certificate(having UDIN) Balance Sheet and profit and loss account of the Bidder for FY 2020-21, 2021-22 and 2022-23 as per clause 15.2 |
| 11 | Non-Black List self-Declaration on bidding firm's letter head as per clause 15.1(iv) |
| 12 | Form 6 and Form 7 as per clause 15.1 (iii) |
| 13 | Any other document as per clause 15 and Annexure 1 (Form 5) |

16. **Delivery schedule of Machines** – As per schedule give in Section-1, Table-1.

17. **Payment Terms:** Payment shall be released processing unit wise upon completion of Supply, Installation, Testing and commissioning (SITC) of all the machines listed under that particular code as mentioned in clause 3 (Table 2) above.

Example: Payment will be released in below mentioned stages for Code 101 “Chironji Processing Unit if the bidder has completed SITC for all the machines specified under code 101

- i. 60% on proof of dispatch and submission of all documents, Quality assurance/Pre dispatch inspection acceptance of the machine's unit wise (i.e., Code 101...etc.)
- ii. 20% on Installation & Commissioning of Machine
- iii. 10% After Successfully Trial of 15 days.
- iv. 10% After Completion of initial 6 Months Training.

17.1 Payment for **TRAINING & Skill Enhancement for O&M of the Processing Machines/ Equipment** (Period for which this service category may be availed by Federation will commence after the completion of vendors contractual obligation for mandatory training as per clause 31.1 of Section III “Special Condition of Contract”, as per the tender document. This service shall be availed as per requirement of Federation.)

- i. Payment shall be made by Federation on monthly basis upon submission of Monthly invoice and Attendance record for the deployed human resource and Payment shall be made within 15 days from the date of submission of invoice and supporting documents to Federation by Bidder

18. **Person Authorised to Submit Tender**

- i. Person or persons signing the tender form shall state in what capacity he or she or they are signing the tender form e.g., as sole proprietor of the firm concerned or as Managing Director or Director or Secretary of Limited Company.

- ii. In the case of partnership firm, the names of all the partners should be recorded and the tender form should be signed by all the partners or their duly constituted attorney having authority to bind all partners in all matters pertaining to the contract as recorded in the power of attorney or in the partnership deed.
True copy, (self-attested) of the Registered "Partnership Deed" should be submitted along with the tender form failing which the tender shall be liable to be rejected.
It shall be obligatory on the part of every partner of the firm, which enters into agreement to fulfil the terms and conditions of the agreement during the currency of the contract thereof, notwithstanding the dissolution of the partnership in the meantime.
 - iii. In the case of a limited company, the tender form shall be signed by a person empowered to do so by the company, copy of Certificate of incorporation of the company and the letter authorizing the person signing the tender documents shall be submitted to the tender form failing which the tender shall be liable to be rejected.
 - iv. In the case of Hindu undivided family, the names of the family members should be submitted with the tender form and 'Karta' who can bind the family should sign the tender form.
 - v. The person signing the tender form on behalf of another or on behalf of a Firm shall enclose with the tender form power of attorney or deed duly executed in his favour or the partnership deed giving him such power showing that, he has the authority to bind such other person or the firm, as the case may be in all matters pertaining to the contract.

If the person so signing the tender form fails to submit the said power of attorney or partnership deed, his tender shall be liable for summary rejection.
 - vi. The power of attorney should be signed by all the partners in the case of partnership firm, by the proprietor in case of a proprietary concern and by the person who by his signature can bind company in the case of limited company. In the case of Hindu undivided family, the power of attorney should be signed by the 'Karta' who by his signature can bind the family.
- s
19. A bidder shall not have conflict of interest. All bidders found to have conflict of interest shall be disqualified. A bidder may be considered to be in conflict of interest with one or more parties in this bidding process, if, including but not limited to:
 - a) They have controlling shareholders in common or
 - b) They receive or have received direct or indirect subsidy from any of them or
 - c) They have the same legal representative for purposes of this bid or
 - d) They have a relationship with each other, directly or through common third parties,
 - e) that puts them in a position to have access to information about or influence on the bid of another bidder or
 - f) A bidder participates in more than one bid in this bidding process. Participation by a bidder in more than one bid will result in the disqualification of all bids in which the party is involved.
 - g) A bidder participated as a consultant in the preparation of the design or technical specification of the contract that is subject of the bid.
 20. The tenders submitted online should be signed electronically with a Digital Certificate to establish the identity of the bidder tendering online. The bidder can obtain the Digital Signature Certificate as per the instructions of step 1 of clause 1 of enclosed **Section - II**.
 21. In order to participate in the tender, the bidder is required to get registered on the e-Procurement portal (<https://cgmpfedtenders.abcpocure.com>).

22. Only after online registration of the bidder, the bidder shall be allowed to participate in the tenders floated by the Federation using the e-Procurement System.
23. After obtaining the Digital Certificate as mentioned in above S.No. 19 and successfully installed on their system, the bidder has to be online registered through "New Bidder Registration" page of the e-Procurement portal (<https://cgmfpfedtenders.abcprocure.com>) and mapped their Digital Certificate.
24. The bidders will have to submit (Upload Scan Copies / fill) his / her offer / credentials online as required in the tender in the online templates in relevant envelopes.
25. The bidders may refer User Manual for bidders available online to perform their online activities. **(Section-II)**
26. The Managing Director, CGMFP(T&D) reserves the right to accept / reject any or all the tenders without specifying any reason thereof. He may relax any tender condition.
27. Conditional offer other than specified terms and conditions shall not be accepted.
28. **TIME IS THE ESSENCE FOR THIS PROJECT.**
29. Bidders who are selected after opening of the financial tender have to supply the equipment/ machines within 60 days from the date of issue of sanction letter.
30. For the interpretation of the tender conditions, the decision of the Managing Director of Chhattisgarh State M.F.P Federation will be final.
31. All the terms & conditions of this tender notice will be binding on the supplier / bidder.
32. The amendments, if necessitated in this tender will be posted on Federation's website **www.cgmfpfed.org** and e-Procurement portal **<https://cgmfpfedtenders.abcprocure.com>** only. The bidder should regularly view the above website and portal till the opening of financial tender so that he can take the appropriate action according to the amendments.
33. The online e-tender notification is already available on the Federation's website www.cgmfpfed.org and e-Procurement portal **<https://cgmfpfedtenders.abcprocure.com>** Only, the entities registered with service provider e-Procurement Technologies Ltd (abc Procure) can tender in the tender.

MANAGING DIRECTOR

CG State MFP (T& D) Co-op Federation Ltd.
Raipur.

SECTION-II

Instructions for the Submission of the Online Tender

Note: The following steps need to be carried out for online submission of the Tender. Detailed instructions for each of the steps are given in the Bidder's Manual on the Home Page of <https://cgmpfedtenders.abcprocure.com>

1. Sequence of steps for online tender submission:

Step 1 – To obtain Digital Signature Certificate (DSC):

The DSC is issued by an approved certifying authority, authorized by the Controller of Certifying Authorities (CCA), Government of India. The individual may obtain information required for issuance of a Class II / Class III DSC from the Controller of Certifying Authorities (www.cca.gov.in). The bidder will have to obtain DSC from <https://cgmpfedtenders.abcprocure.com> or any other CCA approved agency.

DSC is issued upon receipt of mandatory identity proofs and verification letters attested by a Gazetted Officer. Only upon the receipt of the required documents, a DSC can be issued.

Important Note: The offers submitted online should be signed electronically with a DSC to establish the identity of the bidder. In case, during the process of a particular tender, the user loses his/her DSC (e.g., due to virus attack, hardware problem, operating system problem etc.) he may not be able to submit the offer online. Hence the users are advised to back up the certificate and keep the copies at safe places under proper security to be used in case of emergencies.

In case of online tendering, the DSC issued to the authorized user of a firm and used for electronic tendering will be considered equivalent to no-objection certificate / power of attorney to that user. The firm has to authorize a specific individual via an authorization certificate signed by all partners to use the DSC as per Indian *IT Act 2000*. Unless the certificate is revoked, it shall be assumed to represent adequate authority of the user to submit tender on behalf of the firm for the Chhattisgarh State Minor Forest Produce (Trading & Development) Co-op. Federation Limited as per *Information Technology Act 2000*. The DSC of this authorized user will be binding on the firm. It shall be the responsibility of management / partners of the registered firm to inform the Certifying Authority or Sub-Certifying Authority, if the authorized user changes, and apply for a fresh Digital Signature Certificate and issue a fresh '**authorization certificate**' for the new user.

The same procedure holds true for the authorized users in a Private / Public company. In this case, the authorization certificate will have to be signed by the directors of the company.

Step 2 – Online registration of intending bidder:

In order to participate in the tender, the bidder is required to be registered on the e-Procurement portal (<https://cgmpfedtenders.abcprocure.com>). Only after online registration of the bidder, the bidder shall be allowed to participate in the tenders floated by the C.G.M.F.P. Federation using the e-Procurement System.

The following Registration Fee will be charged by the Service Provider (i.e. e-Procurement Technologies Limited) from the bidder:

| Sl. No. | Description | Charges | Service Tax | Total Amount |
|---------|-------------|---------|-------------|--------------|
|---------|-------------|---------|-------------|--------------|

| | | | | |
|----|---|-----------|--------------|-----------|
| | | | @ 18% | |
| 1. | Online Registration (Valid for One Year) | Rs. 500/- | Rs. 90/- | Rs. 590/- |

Documents required for Registration with the e-Procurement portal

(I) In case of Renewal – No documents required for renewal of registration on the e-procurement portal.

(II) In case of New Registration – The following documents required along with online registration form :-

(a) Individual or Proprietorship Firm –

Any one ID Proof and One Address Proof (Attested by Banker or Notary or Gazetted Officer as well as Self Attested)

| ID Proof | PAN Card | Address Proof | Electricity Bill |
|-----------------|-----------------|----------------------|------------------|
| | Passport | | Passport |
| | Voter ID | | Voter ID |
| | Driving License | | Driving License |
| | Aadhaar Card | | Bank Pass Book |

(b) Partnership Firm –

(i) Any one ID Proof and One Address Proof (Attested by Banker or Notary or Gazetted Officer as well as Self Attested)

| ID Proof | PAN Card | Address Proof | Electricity Bill |
|-----------------|-----------------|----------------------|------------------|
| | Passport | | Passport |
| | Voter ID | | Voter ID |
| | Driving License | | Driving License |
| | Aadhaar Card | | Bank Passbook |

(ii) Partnership Deed details which have to be attested by partners with their company seal.

(c) Pvt. Ltd. Company –

(i) Any one ID Proof and One Address Proof (Attested by Banker or Notary or Gazetted Officer as well as Self Attested)

| ID Proof | PAN Card | Address Proof | Electricity Bill |
|-----------------|-----------------|----------------------|------------------|
| | Passport | | Passport |
| | Voter ID | | Voter ID |
| | Driving License | | Driving License |
| | Aadhaar Card | | Bank Passbook |

(ii) Any one of the Organization proofs issued by Government (Attested by authorized signatory of Organization along with organization seal)

- **Certificate of Incorporation**
- **Articles of Incorporation**
- **Memorandum of Association**

(d) Hindu Undivided Family (H.U.F) –

Any one ID Proof and One Address Proof (Attested by Banker or Notary or Gazetted Officer as well as Self Attested)

| | | | |
|-----------------|-----------------|----------------------|------------------|
| ID Proof | PAN Card | Address Proof | Electricity Bill |
| | Passport | | Passport |
| | Voter ID | | Voter ID |
| | Driving License | | Driving License |
| | Aadhaar Card | | Bank Passbook |

(e) Others –

(i) Any one ID Proof and One Address Proof (Attested by Banker or Notary or Gazetted Officer as well as Self Attested)

| | | | |
|-----------------|-----------------|----------------------|------------------|
| ID Proof | PAN Card | Address Proof | Electricity Bill |
| | Passport | | Passport |
| | Voter ID | | Voter ID |
| | Driving License | | Driving License |
| | Aadhaar Card | | Bank Passbook |

(ii) Any other relevant documents-

The scanned copies of all required documents as above and payment proof of required fees for New Registration and payment proof of required fees for renewal are required to be submitted by the intending bidder to e-Procurement Technologies Limited (abcProcure). After verification of the above documents the e-Procurement Technologies Limited (abcProcure) will register the Bidder and inform by the e-mail accordingly.

After obtaining the Digital Signature Certificate successfully installed on their system, the bidder have to be online registered through “**New Bidder Registration**” page of the e-Procurement portal (<https://cgmpfedtenders.abcprocure.com>) and mapped their Digital Signature Certificate.

After online registration your registration will be approved by the Service Provider and intimate the same to the bidder. The bidder will be informed about the Bidder’s Code, login Id & password. The login Id and password will be required for online tender preparation and the Bidder’s Code will be used for making EMD payment through RTGS / NEFT mode, if opted for.

Code will be used for making EMD payment through RTGS / NEFT mode, if opted for.

Step 3 – Online tender preparation

Technical Bid Envelope (Folder)

1. Filling of Bidder’s Information - Form No. 1 of Section –VI
2. E.M.D. and cost of Tender Details – Form No. 2 of Section –VI
3. Documents to be uploaded - Form No. 5 of Section –VI

Financial Bid Envelope (Folder)

1. Financial Format – Form 1 of Section -VII

Step 4 – Online payment of Cost of Tender+ EMD

Cost of Tender + EMD can be paid online through Net-banking / Debit Cards / Credit Cards / RTGS / NEFT mode. In case, RTGS / NEFT mode is opted for, the detailed procedure is given below at point no. 2.2.

It will be solely the bidder's choice to select any of these payment options viz. Net-banking / Debit Cards / Credit Cards / RTGS / NEFT, best suited to him. It is understood that the bidder is aware of the payment cycle and other technical requirements / payment process under each of these modes. It is bidder's responsibility to see that the amount of Cost of Tender + EMD is credited to C.G.M.F.P Federation.

Step 5 – Final submission of the tender.

2. Other Information:

2.1 Set-up of Machine:

In order to operate on the e-Procurement System, following minimum operating system and hardware is required.

- Windows XP with service pack 3
- Windows vista / windows 7
- Browser Internet Explorer 7, 8 or 9
- Minimum bandwidth 512 kbps
- Minimum RAM 2 GB

2.2 Procedure of payment of Cost of Tender + EMD through RTGS / NEFT mode:

Since RTGS / NEFT payments are settled by RBI in batches, intended Cost of Tender + EMD amount is required to be paid at least one day in advance of online tender submission by following procedure:

- A.** Please mention the following details while making the RTGS / NEFT payment from your Bank:
- (i) Beneficiary account number – This will be in the following format:
<CGMF+ Bidder Code>
For example, in case your Bidder Code is ABC66215, the beneficiary account number will be **CGMFABC66215**.
- (ii) Beneficiary bank branch - **ICICI Bank, CMS, Mumbai**
- (iii) Beneficiary IFSC code - **ICIC0000104**
- B.** After completing the online tender preparation formalities, select RTGS / NEFT payment option at the Cost of Tender + EMD payment screen. Upon doing so, you shall be able to view the funds already remitted by you through NEFT / RTGS as available balance in beneficiary account. Bidder should note that available balance against their name in ICICI Bank is not Cost of Tender+ E.M.D amount available with C.G.M.F.P Federation.
- C.** Please proceed to deposit the Cost of Tender + E.M.D from available balance. Upon doing so, the required amount to be paid for the Cost of Tender+ E.M.D, shall get appropriately deducted from the amount remitted and payment of Cost of Tender+ E.M.D shall be confirmed & receipt will be generated in real time.

- D. In case there is excess remittance i.e., money not transferred for use as Cost of Tender + E.M.D, the refund of the same can be claimed by the bidder simultaneously. On submitting refund request, the amount would be transferred in the bank account opted by you by next working day.
- E. In case, bidder wants to utilize the excess fund (i.e., the remaining available balance) for participating in next round of tender by Federation under e-Procurement portal, they may do so instead of taking refund.
- Please feel free to get in touch with our e-procurement support team / ICICI Bank support team in case any clarification is required.**

2.3 Submission of Online Offer:

CGMFP Federation will not be responsible for any failure on part of the bidder in submission of the Tender and/or the Cost of Tender+ EMD etc. before scheduled time and date, for any reason whatsoever, including, inter-alia, non-credit of said amounts of Cost of Tender+ EMD and therefore no claims shall be entertained on these grounds.

Under this online payment system for e-Tendering, the tenders will not be submitted / received by CGMFP Federation unless the Cost of Tender+ EMD is received / credited before scheduled time and date. Hence, bidder shall remit the said amount well in advance. It is clarified that the Tenders will not be considered for opening if Cost of Tender + EMD is not received/ credited before schedule time and date, for any reason whatsoever.

The bidder is advised to submit his / her tender as well as pay the Cost of Tender + EMD amount well before the cut-off time and date to avoid any inconvenience on account of any problem e.g., system slow down or network problem.

2.4 Helpline:

For any assistance regarding Registration on e-Procurement portal, DSC, online tender form submission and other points of e-tendering process, please contact our service provider: -

Important Note for Bidders for New E-Tendering portal

abcProcure (M/s. e-Procurement Technologies Ltd.) is conducting e-Tenders for Chhattisgarh State Minor Forest Produce (Trading & Development) Co-operative Federation Limited (**CGMFPFED**) for sale of various Minor Forest Produces and for Procurement of various Goods, Services and works. It is to herewith inform to all existing bidders who are registered on <https://cgmfped.abcprocure.com> that abcProcure (M/s. e-Procurement Technologies Ltd.) is introducing new e-Tender Portal for foresaid tendering activities for CGMFPFED.

For introducing the new e-Tender portal, Training was scheduled whole month round in Mar. 2022.

It is to inform all the existing bidders that abcProcure (M/s. e-Procurement Technologies Ltd.), has shared with you your Log-IN ID, New Password for new portal (<https://cgmfpedtenders.abcprocure.com>) on your registered email ID on 16.03.2022. All existing Bidders registered on <https://cgmfped.abcprocure.com> shall use Log-In and new Password shared over email on 16.03.2022 to login on new e-Tendering portal i.e., <https://cgmfpedtenders.abcprocure.com>.

After logging in on new e-Tendering portal, bidders are mandatorily required to change their password and attach DSC. Once DSC is attached, bidders are required to get it verified from abcProcure (M/s. e-Procurement Technologies Ltd.) by getting in touch with DSC verification Team reachable on +91-9099090830 / +91-6353217080 and info@AbcProcure.com.

Further, All the bidders are issued new e-Wallet / Virtual Account for remitting EMD in new e-Tender portal which has been shared on your registered E-Mail ID on 10.03.2022. Bidders are required to use the same e-Wallet / Virtual account for remitting payment by NEFT/RTGS for e-Tender which are floated on new e-Tendering portal i.e., <https://cgmpfedtenders.abcprocure.com>. Bidders are strongly requested to not to use their current/ existing e-Wallet / Virtual account for new e-Tender portal. The same is applicable for old e-Tendering portal only and not valid for new e-Tendering portal. Please take strong note of this.

Bidders can download Bidder Manual to get familiar with the new portal from <https://cgmpfedtenders.abcprocure.com/EPROC/ajaxcall/downloadfile/23/577>

For New Registration/DSC Support/Profile Approval, please call or write on:

Cell Number: +91-9099090830 / +91-6353217080

e-mail at: info@AbcProcure.com

Call/write for e-Tender Submission / e-Auction Bid Support:

Phone Numbers: +91-79 6813 6854/50/48/49

Cell Number: +91-9374519729 / 9904406300 / 9510812971

Write by e-mail at: Support@AbcProcure.com

Call/write for e-Payment Related Queries:

Phone Numbers: +91-9374519729 / 9081000427

Write by e-mail at: Payment@eptl.in

Office Hours:

Monday to Friday - 10:00AM to 07:00PM

1st,3rd & 5th Saturday -10:00AM to 06:00PM

2nd & 4th Saturday - Holiday

For any assistance regarding banking transactions, please contact ICICI Bank, Civil Lines, Raipur at the following numbers:

Mr. Pawan Gurung – 7389919383

Ms. Shubhangi Gupta – 9993822514

MANAGING DIRECTOR

Chhattisgarh State Minor Forest Produce
(T&D) Co-op. Federation

SECTION-III

SPECIAL CONDITION OF CONTRACT

1. The supplier / bidder shall be deemed to have carefully examined the terms and conditions, specifications, etc. of the machines to be supplied before submission of bid.
2. The supplier / bidder shall not assign or sub-let his contract or any substantial part thereof to any other agency without the prior written permission from the CGMFP.
3. All the Machines/equipment's as per specification supplied shall be of best quality. In case of any equipment/accessories/parts supplied is found inferior/damaged, the same shall stand rejected and loss caused to CGMFP shall be recoverable from the supplier.
4. Authorized representative of CGMFP shall have at all the time access to examine the materials and workmanship of the machines.
5. The supplier should ensure that the equipment's/Machines are inspected prior to dispatch and acceptance certificate from CGMFP Authorised official/Institution is obtained.
6. Transit insurance during transportation of the consignment shall be responsibility of the supplier. Proper packaging before dispatch shall be the sole responsibility of the supplier.
7. All necessary documents like Invoice Copy, GR/RR bill, E waybill, Tax Invoice Copy, Quality acceptance report etc. shall be handed over to the transporter at the time of dispatch of equipment from supplier works.
8. The removal of rejected machines, if any, within fifteen days shall be suppliers responsibility.

If the supplier fails to lift the materials within the above prescribed period, extra storage charges may be leviable at the sole discretion of purchaser whose decision shall be binding and final for the supplier.

9. The Managing Director, CGMFP can repudiate the contract of supply at any time, at the risk and cost of the supplier, if the supplies are not made up to satisfaction of such contract.
10. EMD shall be adjusted in the performance security or refunded after receiving performance security for the amount specified in the Tender document.
11. The successful bidder will have to submit a Performance security of equivalent to 5% of the Contract /Order value, prior to the execution of agreement, with validity 60 days beyond the period of expiry of the Warranty/ Guarantee period, in form of crossed Demand Draft/Pay order/Fixed Deposit Receipt/Bank Guarantee from a commercial bank in favour of the CGMFP Raipur, payable at Raipur.
12. If the security deposit is not furnished within the specified time, the letter of award may be liable for cancellation and EMD will be forfeited, along with such other penal action like black listing of the bidder for future business with the Federation for a maximum period of 3 years.
13. Bank charges on payment remittance shall be on supplier account.

14. Supply / Installation / Delivery Schedule: The supplies shall be made strictly as per the following schedule-
 - i. Delivery and final installation required: For Indian manufacturer - Within 60 days from the Date of issue of work award letter or as specified in the supply order.
 - ii. Failure to adhere on schedule as specified in purchase order shall make supplier liable to forfeit Security deposit and/or any other penal action at the sole discretion of the purchaser.
15. Supply/ installation and Hands-on training of Machines will be done by the supplier free of cost for the duration of 6 months from the date of completion of Trial run.
16. The cost of damage if any during transportation and installation will be borne by the supplier.
17. A warranty of one year will be given by the supplier for any manufacturing defect in the machines.
18. Any change / corrigendum/ extension of opening date in respect of this tender shall be issued through websites only and no press notification will be issued in this regard. Bidders are therefore requested to regularly visit our website for updates.
19. **Penalty for Delayed Services / Liquidated Damages:** In case the firm does not complete the supply within the laid down agreed delivery period as per contract, liquidated damages will be charged @ 0.5% per week or part thereof subject to a maximum of 10% of the contract value.

However, the CGMFP reserves the right to grant extension on delivery schedule with or without levy of LD and/ or cancel the contract.

20. **Evaluation of Tender: Single stage bidding process is adopted.**

20.1 Technical Evaluation

- i. Evaluation of Technical Tenders to assess their suitability against the laid down parameters in this tender notice
- ii. Bidders must ensure that they enclose all original technical literature and detailed documentary proofs which specifically bring out the compliance of the equipment being offered against the technical specifications mentioned in the tender notice. If necessary, the Bidders may be directed to give a presentation for evaluation by a technical committee constituted for the purpose.
- iii. In case it is not possible to verify compliance of equipment as per technical tender due to lack of adequate documents, in original no reference will be made to bidder and the tender will not be considered further and treated as cancelled.

20.2 Opening of Financial Tender

- i. The price tenders of only those firms, found meeting the laid down specifications in pre-qualification and eligibility criteria shall be opened, evaluated, and considered further.
- ii. It is in the bidders interest to include all relevant and detailed technical data as supporting documents along with their tender.
- iii. The Financial tender will be considered (L1) for total sum of all the Machines/ equipment specified in **clause 1** of the tender notice for the specifications of required Machines/equipment as per **Section 1**.

- iv. The financial evaluation of the bids submitted will be done for all the processing machines in the respective code group as listed in Clause-3 of the Tender Notice. Following methodology shall be adopted to arrive at L1 Rate: Total amount provided under A) Cost of Processing Machine quoted by each bidder shall be assigned 95% weightage and, Manmonth cost provided under B) Engagement of Technical Human Resource(s) Cost shall be assigned 5% weightage. The Financial tender will be considered (L1) based on the methodology mentioned above.
 - v. Lowest Financial proposal (L1) shall be declared successful bidder and the bidder quoting L1 will be awarded the work.
21. **Insurance:** As applicable in the case of imported machines. For indigenous item it will be responsibility of the supplier to supply the material in good condition on FOR basis without involving the risk of the purchaser. The equipment to be supplied will be insured by the vendor against all risks of loss or damage from the date of shipment till such time it is delivered at site of installation.
22. **Payment:** Payment shall be released processing unit wise upon completion of Supply, Installation, Training and commissioning (SITC) of all the machines listed under that particular code as mentioned in clause 3 (Table 2) above.
Example: Payment will be released in below mentioned stages for Code 101 "Chironji Processing Unit if the bidder has completed SITC for all the machines specified under code 101:
- i. 60% on proof of dispatch and submission of all documents, Quality assurance/Pre dispatch inspection acceptance of the machine's unit wise (i.e., Code 101...etc.)
 - ii. 20% on Installation & Commissioning of Machine
 - iii. 10% After Successfully Trial of 15 days.
 - iv. 10% After Completion of initial 6 Months Training.
- 22.1 Payment for **Training & Skill Enhancement for O&M of the Processing Machines/ Equipment:**
- i. Payment shall be made by Federation on monthly basis upon submission of Monthly invoice and Attendance record for the deployed human resource and Payment shall be made within 15 days from the date of submission of invoice and supporting documents to Federation by Bidder.
23. **Conflict of Interest:**
- 23.1 The Agency is required to provide professional, objective and impartial advice and at all times hold the CGMFP interest paramount, strictly avoid conflicts with other assignment/jobs or their own corporate interest and act without any consideration for future work.
- 23.2 Without limitation on the generality of the foregoing, Agency and any of their affiliates, shall be considered to have a conflict of interest under any of the circumstances set forth below:
- 23.3 Conflicting Assignment/job: An Agency (including its affiliates) shall not be hired for any assignment/job that, by nature, may be in conflict with another assignment/job of the Agency to be executed for the same or for another Employer.
- 23.4 Conflicting Relationships: An Agency that has a business or family relationship with a member of the CGMFP staff who is directly or indirectly involved in any part of the project shall not be awarded the Contract, unless the conflict stemming from this relationship has been resolved in a manner acceptable to the CGMFP throughout the selection process and the execution of the Contract.

- 23.5 **Conflicting Activities:** An Agency or any of its affiliates, selected to provide consulting assignment/job for this project shall be disqualified from subsequent downstream supply of goods or works or services resulting from or directly related to this project.
- 23.6 Agency have an obligation to disclose any situation of actual or potential conflict that impacts their capacity to serve the best interest of CGMFP, or that may reasonably be perceived as having this effect. Any such disclosure shall be made to CGMFP, immediately. If the Agency fails to disclose said situations and if the CGMFP comes to know about any such situation at any time, it may lead to the disqualification of the Agency during bidding process or the termination of its contract during execution of the assignment.
24. **Consignee for Delivery:** Managing Director, CGMFP Deobhog, District- Gariyaband, Chhattisgarh
25. **Pre despatch Inspection of Equipment:** The inspection call should be given at least ten days in advance so as to depute the officials of Purchaser/Consultant for the inspection. Such inspection will be of the following categories:
1. Inspection of test certificate /equipment to be witnessed at the manufacturers' premises in accordance with relevant BIS/Agreement Inspection Procedure.
 2. To receive materials at site with manufacturers' Test Certificate(s).
 3. To receive materials after physical inspection at site.
- Similarly, for fabricated equipment, the contractor will first submit dimensional detailed drawings for approval before fabrication is taken up in the factory. Suitable stage inspection at factory also will be made to ensure proper use of materials, workmanship and quality control.
26. **Inspection After Receipt of Machines:** The inspection will be done by the Committee in the presence of the firm representative. The successful bidder will have to provide at his own cost and arrangement technically qualified personnel at the consignee's location for joint inspection. These personnel must be able to unpack, assemble and demonstrate the use of the equipment fully and identified each Part/Machines supplied. Any consumables that are essential will be provided by the supplier free of cost. In case of receipt of materials in damaged condition the suppliers will have to arrange the replacement of machines free of cost. All expenses in this regard will be borne by the supplier.
27. **Packing & Marking:** The packing and preservation of the supplied machines shall be roadworthy so that it may provide their safety during transit period. The supplier shall guarantee that the packing is strong enough to withstand the safety of the machines during transport. The packing should satisfy the security seal in the clearing warehouse and shall carry the fragile or other markings as required. All damages which may occur as a result of defective packing shall be borne by the seller.
28. **Guarantee /Warranty:** Comprehensive onsite Guarantee/Warranty is required. Warranty Terms period will start from the date of installation of Machinery.
- In case at installation stores/part of stores are found defective /damaged during or after delivery to consignee, the suppliers will replace or repair the store under warranty at consignee's location in India free of cost.
- If in any case it is required to be sent back to the OEM Works, Bank Guarantee equivalent to the cost of equipment is required to be submitted before lifting the store. All expenses in this regard will be borne by the supplier.

29. **Dispute settlement:** The dispute arising out of this contract shall be subject to the jurisdiction of Indian laws & court at Raipur.
30. **Arbitration:** Shall be as per Indian law and Sole arbitrator be appointed by the MD, CGMFP and his decision will be final and binding to both parties (Supplier and Purchaser).
31. **Training:**
- 31.1 Supplier shall associate in skill enhancement / hands-on-training for the operation and handling of machine to operator for Six months after commissioning. All expenses in this regard will be borne by the supplier.
- 31.2 Training & Skill Enhancement for O&M of the Processing Machines/ Equipment -** Period for which this service category may be availed by Federation will commence after the completion of vendors contractual obligation for mandatory training as per clause 31.1 above. This service shall be availed as per requirement of Federation, and an intimation to the successful bidder will be sent in writing to deploy resources with relevant experience for a particular period at the Incubation Center, to provide this service to Federation. And the payment for the same shall be made as per clause 21.1 (i) above.
32. **Price:** The price quoted shall be on firm and fixed basis and should be reasonable. Negotiation, if any shall be at the discretion of CGMFP.
33. **Penalty for use of undue influence:** The seller should undertake that he has not given offered or promised to give directly or indirectly any gift, consideration, reward, commission, fees brokerage of inducement to any person in service of the Purchaser or otherwise in procuring, the contract or forbearing to do or for having done or for borne to do any act in relation or execution of the contract or any other contracts with the CGMFP for showing or for bearing to show favour or disfavour to any person in relation to the contract or any other contract in the CGMFP. Any breach of the aforesaid undertaking by the seller or any one employed by him or acting his behalf whether with or without the knowledge the seller or the commission of any offers by the seller or any one employed or acting on his behalf, as defined in Chapter-IX of the IPC, 1860 or the Prevention of Corruption Act, 1947 or any other Act enacted for the Prevention of Corruption shall entitle the purchaser to cancel the contract and all or any other contract with the CGMFP seller and recover from the seller the amount of any loss arising from such cancellation. A decision of the purchaser or his nominee to the effect that a breach of the undertaking had been committed shall be final and binding on the seller.
Giving or offering of any gift, bribe or inducement or any attempt at any such act on behalf of the seller towards any officer /employee of the purchaser or to any other person in a position to influence any officer /employees of the purchaser for showing any favour in relation to this or any other contract shall render.
34. **Laws Governing the Contracts:** The contracts shall be governed by the laws of India for the time being in force. The contract shall be interpreted in accordance with these laws.
35. **Termination of Contracts:** Time shall be the essence of the contract. The purchaser (CGMFP) shall have the right to terminate the contract without any notice in part or in full in any of the following cases:
- The delivery of the material is delayed for causes not attributed to Force Majeure after the scheduled date of delivery.
 - The seller is declared bankrupt or becomes insolvent.
 - The delivery material is delayed due to causes of Force Majeure by more than reasonable time.

- d. In case Performance Security is not furnished within the time period specified by the purchaser.
 - e. Supply in the case of successful Bidder should strictly confirm to the specifications of the equipment being purchased.
 - f. Late /Delayed tenders shall not be considered at all. These will be returned to the firm as it is at their expenses. Post tender revision/correction shall also not be considered.
36. **Acceptance or rejection of offer:** MD, CGMFP reserves the right to accept or reject any tender in part or full without assigning any reason thereof.

The successful bidder should submit order acceptance letter and execute agreement within 10 days from the date of issue of letter of award.

The agreement shall be executed between Managing Director, District Union, Gariyaband and Supplier and all further correspondence and payments to supplier shall be processed from the office of MD, District Union, Gariyaband.

- 37. The Chhattisgarh State Minor Forest Produce (T & D) Co-operative Federation Ltd. shall have the right to accept or reject any or all tenders without assigning any reason thereof.
- 38. The Managing Director, Chhattisgarh State Minor Forest Produce (T & D) Co-operative Federation Ltd. reserves the right to increase or decrease quantity mentioned in the tender notice or supply order without any claim for compensation from the supplier.
- 39. If the rate quoted by the two or more bidders is the same, the lowest bidder will be decided by drawing the lottery after opening of the tenders.
- 40. For the interpretation of the tender conditions, the decision of the Managing Director, Chhattisgarh State Minor Forest Produce (T & D) Co-operative Federation Ltd. will be final.

These conditions will constitute the conditions of contract between Supplier and CGMFP after the supplier unconditionally accepts Letter of award is issued by the federation.

Note: - Since the document is being submitted as a part of digitally signed tender document in e-tendering process, so the physical signatures of the bidder and Managing Director, Chhattisgarh State Minor Forest Produce (Trading & Development) Co-op. Federation Limited are not available on this document.

MANAGING DIRECTOR
CG State MFP (T& D) Co-op Federation Ltd. Raipur

SECTION-IV

SCOPE OF WORK

1. Overview

This section contains the brief idea of the scope of work, supplementary information etc. regarding the work to be executed under this tender and may vary as per site requirement. In case of any change the decision of the Managing Direction will be final and binding to the contractor. The work however shall be executed as per technical specification.

The work consists of **“Supply, Installation, Testing, Commissioning, Integration and Training of following processing machines at Incubation Center Deobhog, District-Gariyaband (C.G.)”**

| | | | |
|-----|---|-----|--------------------|
| 101 | Chironjee Processing | 104 | Primary Processing |
| 102 | Neem/Mahua/Kusum/Groundnut Oil Processing and Chikki Making | 105 | Lac Processing |
| 103 | Masala Processing | 106 | Pulse Milling |

2. The General Scope of Work

a) Mechanical

The equipment shall be supplied complete in all respects with all necessary accessories and commissioning spares for operating it as per the technical specification.

b) Electrical

Electrically operated equipment shall be complete with necessary starters, control panel, push button stations including emergency push button, cabling, earthing etc. as required. All electrical items and related works for the equipment/machinery as per the battery limit specified in the technical specification shall be provided.

c) Instrumentation & Automation

Instrumentation & Automation related items/works related to the equipment/machinery as required shall be provided.

d) Painting

Painting shall be executed as per relevant standards.

e) Thermal Insulation

Thermal insulation shall be supplied & installed as per the requirement wherever such heat generating/ cooling system and / or piping are involved.

f) Design

The standards/general design requirements shall be as per the OEM and relevant Indian/International standards as applicable.

All safety precautions shall be taken care in the design and should be incorporated in the equipment or as per the instruction given in the specifications.

g) Piping

Related piping works as per the battery limit specified in the technical specification. The piping works have to be carried out as per relevant standards.

h) Inspection & Testing

Quality Assurance Plan/Inspection and Test Plan shall be submitted along with the bid. Inspection & Testing shall be carried out as per good engineering practice. Apart from such inspection by Purchaser, the Supplier shall comply with all other inspection requirements of the applicable/specified code or by statutory authorities having jurisdiction over the installation.

i) Statutory Clearances

The equipment shall meet all statutory requirements including but not limited to standards of Chhattisgarh State Electrical Inspectorate, Pollution Control Board, Inspectorate of Factories and Boilers, Department of legal metrology, Chhattisgarh etc. as applicable.

j) Scope of work includes variation or modification of design necessitated during execution, quantity or quality of work, addition/deletion/ substitution/ modification of any work, under the instruction of CGMFPFED/Consultant. Such requirements shall deem to be within the scope of work within contract value and instructions shall be complied forth with.

l) Defect Liability Period/Warranty

Defect Liability Period/Warranty is One year from date of Commission.

3. Training & Skill Enhancement for O&M of the Processing Machines/ Equipment:

Period for which this service category may be availed by Federation will commence after the completion of vendors contractual obligation for mandatory training as per clause 31.1 of Section III "Special Condition of Contract ", as per the tender document. This service shall be availed as per requirement of Federation, and an intimation to the successful bidder will be sent in writing to deploy resources with relevant experience for a particular period at the Incubation Center, to provide this service to Federation.

MANAGING DIRECTOR

CG State MFP (T& D) Co-op Federation Ltd. Raipur

SECTION-V

TECHNICAL SPECIFICATIONS

1. OVERVIEW

These instructions to bidders form a part of the tender document and shall be read in conjunction with the invitation to tender under other conditions of contract.

The technical requirements given hereunder are only indicative and not descriptive. The supplier shall ensure that the equipment and associated accessories supplied are complete in all respects for operation and guaranteed performance. Items which are not covered under the technical specification, but are actually required, shall be carried out as per relevant IS standards or as per manufacturer's standard specification approved by Accepting Authority or as directed by Managing Director.

| Machine Code | Machines | Qty (in Nos.) | Specification |
|--------------|--|---------------|--|
| 101 | Chironjee Processing Unit Machine | | |
| 10101 | Double shelling machine | 2 | i) Capacity 100 Kg/ Hr, ii) Sheller Size – 14", iii) Motor - 2 HP 1440 (3) Three Phase, iv) Chalna Size – 8' x 3', v) Production Capacity – 300 Kg per Hr., vi) Sheller Hopper Capacity – 1.5 Quintal Motor 2 HP Three Phase 440 V, Horizontal plate type mill with a provision to adjust the clearance between plates. One plate should be stationary while other plate should rotate (Plate Material SS-316). Feed hopper of 25 kg capacity or more with feed control mechanism. The machine should have a 3-screen system (Screen Material ss-304) to separate husk, broken kernel and whole kernels. Provision should be there to separate lighter particles using a blower and a cyclone dust collection system |
| 10102 | Chalna Double Compartment | 1 | i) Capacity - 100-150 Kg/ Hr, ii) Chalna Size – 8' x 3', iii) Motor - 1 HP 1440 (3) Three Phase. 440 V, 3 perforated sieves of different sizes (depending upon guthli sizes) fitted in a reciprocating shoe via cam mechanism. Machine should separate bigger, medium and small size guthli. Provision must be there to change the screens with different aperture size screens and screen cleaning mechanism should be in place. Sturdy frame with minimum vibration, Feed hopper of 50 kg capacity with feed control gate. Fitted with starter, power transmission mechanism. |

| | | | |
|------------|---|---|---|
| 10103 | Chironjee Dana Separator | 1 | i) Capacity – 2 Ton per Hr.(matching capacity) , iii) Chalna Size – 8' x 3', iv) Motor - 3 HP 1440 Three Phase, v) Separate – Small, Medium, Large, Hathu |
| 10104 | Dryer Machine | 1 | i) Capacity – 100 Kg per Hr.(Batch size), ii) Electric Operated, iii) Small Blower – 1 Nag, iv) Hitter – Tray Model, v) Tray – 4 Compartment Dryer should have 4 Compartment each with 3 number of Trays (Size 600x450x40 mm), made from 20 Gauge thick SS 304. |
| 10105 | Air aspirator with cyclone dust collector | 1 | i) Dust Collector ii) Motor - 3 HP 1440 RPM Three Phase |
| 10106 | Vacuum packaging machine with nitrogen flushing | 1 | i) Capacity – 3 Ton per day, ii) Packaging Size – 10g, 25 g 50 g,100 g, ,250 g, 500 g and 1000 g Vacuum packing to ensure increased shelf life with nitrogen flushing. Packaging should be Weighment Type, suitable for Body and structure made of SS-304; Nitrogen cylinder one of 20 kg capacity. Fitted with safety lids, digital pressure gauges, digital control for changing vacuum, and auto mode operation for vacuum/flushing Packaging Capacity-3T in one shift (8 hour) working. |
| 10107 | Weighing Machine | 1 | i) Capacity - (100 – 200 kg.) ii) 10/20 gm) |
| | | | |
| 102 | Neem/Mahua/Kusum/Groundnut Oil Processing and Chikki Making Unit | | |
| 10201 | Oil expeller | 3 | i) 125- 140 Kg/ Hr ii) Sheller Size – 22"x 4" |
| 10202 | Round automatic feeding + cooking kettle with steam jacket | 2 | i) 50L - 250 L Kg/ Hr ii) Sheller Size – 100L |
| 10203 | Long automatic feeding + cooking kettle with steam jacket | 1 | i) 60 KW Power ; ii) 2 Ton capacity Heavy Duty Double Bearing System, Oil expeller chamber size 22" x 4"(550x100mm) crushing capacity up to 100-120 kg/hr. complete with unique facility to open chamber cage on hinges (no weight lifting) & with facility to change cake thickness while running expeller (without stopping expeller) with "OIL BATH" system and having Helical Gear set arrangement. Round automatic feeding + cooking kettle with steam jacket + magnet (to protect expeller from getting |

| | | | |
|------------|--|---|--|
| | | | damaged by iron metal). Motor – 12.5 HP (960 rpm) Three Phase 440V, with switch gear. Channel Base Frame suitable for oil expeller & motor. Pulley 36 x 3 x C for oil expeller. V-belts & Plain Belts for above M/c. |
| 10204 | Filter press 16" X 16" - 16plate complete | 2 | i) SIZE - 16" x 16" |
| 10205 | Centrifugal oil separator | 1 | 9000 LPH capacity |
| 10206 | Seed decorticator | 2 | i) 300 Kg/ Hr i) Motor - 2 HP 1440 rpm Single Phase |
| 10207 | Electric motor 12.5 hp | 3 | i) Motor – 12.5 HP - 3 phase |
| 10208 | Conveyor complete | 3 | i) Motor –1.5 hp |
| 10209 | Grinding / hammer mill / multipurpose pulveriser | 1 | i) 100 Kg/ Hr i) Motor - 5 HP |
| 10210 | Oil tank | 1 | 3000 ltr |
| 10211 | Extra filter pump with 1.5 hp | 1 | |
| 10212 | Strong table | 2 | Table Top Size 3000x1000mm made from SS 304 with robust support/ structure. Height to match with Filter Press. |
| 10213 | Electric boiler complete | 1 | i) Capacity – 30KW |
| 10214 | Bottle filling machine | 2 | 50,100,500,1000 ml bottle, Capacity-200 Bottles/hour |
| 10215 | Ground nut roasting machine | 1 | i) 30 - 50 kg / batch ii) gas auto controller iii) speed controller iv) steering gear tilting |
| 10216 | Ground nut tasta remover | 1 | i) 30 - 50 kg / batch ii) Automatic machine iii) Manual loading |
| 10217 | Concentrator cum mixing tank | 1 | i) 30 - 50 kg / batch ii) Rotating vessel iii) Jaggery melting iv) LPG gas base |
| 10218 | Moulding frame hydraulic press | 1 | i) Hydraulics press ii) 5 tonne |
| | | | |
| 103 | Masala Processing Unit | | |
| 10301 | Hammer Mill | 1 | i) Motor 20 Hp ii) Production Capacity - 100-110 kg per hour |
| 10302 | Air Lock | 1 | i) Motor 1.5 Hp |
| 10303 | Shifter Machine | 1 | i) Motor 3 Hp |
| 10304 | Pulvariser | 1 | i) Motor20 Hp ii) Production Capacity - 100-110 kg per hour |
| 10305 | Cabinet .Dryer | 1 | i) Production Capacity - 250 kg per batch |
| 10306 | Band Sealer machine | 1 | i) Power 600 W |

| | | | |
|------------|--------------------------------|---|---|
| | | | ii) Production Capacity - 6000 - 8000 pouch |
| 10307 | Grader Machine | 1 | i) Motor 7.5 HP |
| 10308 | Auger Filter Packing Machine | 1 | i) Compressor And Conveyor ; ii) Production Capacity - packaging size 20g,50, 100g and 250g. |
| 10309 | Destoner | 1 | i) Motor 2 HP |
| 10310 | Masala Washer Machine | 1 | i) Motor 2 HP (SS) Machine for Washing of Ginger, Turmeric and similar raw material. |
| | | | |
| 104 | Primary Processing Unit | | |
| 10401 | Vertical Bucket Elevation | 4 | i) 15 Feet Height |
| 10402 | Grader (3 Compartment) | 1 | i) Capacity 2 tonne/Hour |
| 10403 | Destoner | 1 | i) Capacity 2 tonne/Hour |
| 10404 | Weighing Machine | 1 | i) Capacity 0 – 500 KG |
| 10405 | Colour Sorter with Compressor | 1 | i) Capacity 500 Kg/Hr ii) MR-1 Chut iii) Compressor – 10 HP For 4 Nos Elevator suitable structure shall be inclusive in the package. Machine should be equipped with suitable Cyclone Dust Collector along with requisite Piping, Pipe fittings ,Valves and necessary consumables for installation of Dust Collector out side the building |
| | | | |
| 105 | Lac Processing Unit | | |
| 10501 | Lac Crusher Machine | 1 | i) Motor 3Hp - 960 Rpm ii) Production Capacity - 100-150 kg per hour |
| 10502 | Lac Washer Machine | 1 | i) Motor 5Hp - 960Rpm ii) Production Capacity - 100-150 kg per batch |
| 10503 | Lac Chalna | 1 | i) Motor 1Hp - 1440 RPM ii) Production Capacity - 100-150 kg per hour |
| 10504 | Lac Winnowers | 1 | i) Motor 1Hp – 1440 RPM ii) Production Capacity - 100-150 kg per hour |
| 10505 | Lac Destoner | 1 | i) Motor - 1Hp - 960 Rpm ii) Production capacity - 100-150kg per hour |
| 10506 | Lac Round Chalna | 1 | i) Motor - 1 Hp - 1440 Rpm ii) Production Capacity - 100-150 kg per hour |
| 10507 | Separator (Single Compartment) | 1 | i) Motor - 1 Hp - 1440 Rpm ii) Production Capacity - 100-150 kg per hour |

| | | | |
|------------|---------------------------|---|---|
| 10508 | Lac Scraper | 1 | i) Motor - 3 Hp - 960 Rpm ii) Production Capacity - 100-150 kg per hour |
| 10509 | Basket Centrifugal (SS) | 1 | i) Motor 2 Hp- 960 Rpm ii) Production Capacity - 100-150 kg per hour |
| 106 | Pulse Milling Unit | | |
| 10601 | Mini Dall Mill | 2 | i) Motor 5 HP ii) Production Capacity - 500-600 kg per hour |
| 10602 | Double Screw Polisher | 1 | i) Motor 2 HP |
| 10603 | Grader | 1 | i) Motor 2 HP ii) Production Capacity - 400-500 kg per hour |
| 10604 | Dryer | 1 | i) Motor 0.5 HP, 2 HP ii) Production Capacity - 500 kg per hour |
| 10605 | Buff Polisher | 1 | i) Motor - 5 HP |
| 10606 | Packaging Machine | 1 | Semi-Automatic, Weighment Type Packing Machine required. Pouch Size 250g,500g,1000g,2000g. Packaging Rate-300Kg/Hour. |
| 10607 | Weighing Machine | 1 | i) Capacity - 0-500 kg |
| 10608 | Holding Bin | 1 | Capacity 500 Kg Material SS304 |

Note

| | | |
|---------|----------------------------|---|
| Note-1. | Accessories and consumable | Each Machine shall have its own control Panel and individually operated. Power supply point shall be provided within 10 Meter radius and all necessary inputs like Cable, Support/Cable tray, Fittings, Switch gears, Machine Lighting (if required) etc. including safety requirement like earthing (if specifically required) shall be in bidder's scope. |
| Note-2 | Training | Vendor shall impart 6 Month training (commencing from the date of completion of trial run) to the incubation center staff |

2. GENERAL REQUIREMENTS

- All contact parts shall be made of food grade materials as specified.
- The equipment supplied shall be complete in all respects with all necessary accessories and
- commissioning spares for operating it for the specified application. Equipment which are either operated under pressure or are likely to develop pressure shall be provided with safety valves, pressure gauges and vents with isolation valves. Electrically operated equipment shall be complete with necessary starters, control panel, push button stations, cabling, earthing etc.
- Electrically heated equipment/machinery shall be insulated as per standard practice.
- All rotating/moving parts shall be provided with adequate guard for safety.
- Pressure testing shall be arranged in the presence of a competent person and their certificate shall be issued before provisional acceptance of the equipment.
- The bidder shall include the cost of all required accessories in the quoted rate.
- The Purchaser reserves the right to procure all the items specified in the tender or part thereof without assigning any reason.

3. CODES AND STANDARDS

- i. The design, manufacture and testing of the equipment shall comply with the latest editions of appropriate Indian standards.
- ii. Unless mentioned otherwise, all applicable codes and standards in their latest editions as published by the Bureau of Indian Standards shall govern in respect of design, workmanship and properties of materials and methods of testing. In case where suitable Indian Standards are not available, generally accepted codes and practices shall be adopted.
- iii. All equipment shall comply with the statutory requirements of the Govt. of India and Government of Chhattisgarh. The equipment fabrication and installation shall conform the provision of statutory and other regulations in force such as the Indian Factories Act, Indian Explosives Regulations, Chhattisgarh State Pollution Control Board, etc. as applicable. Approval of drawings by statutory agencies, if required, shall be arranged by the successful Contractor at no extra cost to the Purchaser.

List of approved makes:

| | | |
|----|---|---|
| 1 | Steel | SAIL, TATA, RINL, JSPL |
| 2 | Valves | Canle/Teckno/Amco/Audco/L&T/BDK |
| 3 | Pipe | Jindal/Tata/Kwality tubes/Zenith |
| 4 | Ball bearings | SKF, FAG, KOYO, NEI, Timken |
| 5 | Primer & Paint | Altek, Berger, Asian, Jotun, ICI, Nerolac, Indian |
| 6 | Anchor Fasteners | HILTI, Fisher, MKT (Germany), Black and Decker India Ltd., MAPEI, SS Fasteners Pvt. Ltd, Rawl plug. |
| 7 | Motors | Crompton/Kirloskar/Siemens/Jyoti/BHEL |
| 8 | Pumps | Alfa Laval, Fristam, Inoxpa, Kirloskar, Mather and Platt, Grundfos, BHEL |
| 9 | Pressure Gauge | General Instruments Consortium, Manometer (I) Pvt. Ltd. Mumbai, Waree Instruments Ltd, Wika Instruments (I) Pvt Ltd, H.Guru, Fiebig, Pricol |
| 10 | Pressure/ Temperature Switches | Indfoss, Switzer Instruments, Schneider, Danfoss |
| 11 | Temperature Gauge | General Instruments Consortium, Pyroelectric, Waree, H.Guru, Fiebig |
| 12 | Solenoid valves | Asco-pneumatic, Janatics pneumatic, Festo |
| 13 | Instrument Cable | LAPP KABEL, TCL, Finolex, Delton cables, Polycab |
| 14 | Control valves | Instrumentation Ltd, Fisher, Dresser, MIL controls |
| 15 | Cable trays | Indiana / Steelite / Rico Steel / Profab Engg / OBO/ Legrand, fixotech |
| 16 | Terminal Blocks | Elmex, Phoenix, Wag |
| 17 | LT Panel boards | CPRI certified panel manufacturer with components of approved makes |
| 18 | UPS (above and including 10kVA) | Socomec, Emerson, Schneider by APC, Reilo, Numeric, GE |
| 19 | Battery Charger | Waves, HBL, Amara Raja, Dubas |
| 20 | SMF/VRLA Batteries | Exide, Amara Raja, HBL |
| 21 | 1.1 kV grade XLPE insulated PVC sheathed Al./ Cu. Cable | KEI, Polycab, Havells, Gloster, Finolex, Torrent, RPG-KEC Cables |

| | | |
|----|------------------------------|--|
| 22 | MCCB | Schneider, L&T, ABB, Siemens, Legrand (Only for MCCB Distribution Boards), Mitsubhishi |
| 23 | Fuses/Fuse carriers | Siemens, L & T, Alstom (EE) |
| 24 | Indicating meters (Analogue) | AE, MECO, L&T, Rishab |
| 25 | Selector switches | Tecnic, Kaycee, L&T |
| 26 | MCB | Legrand, Siemens, Hager, Schneider, L&T, ABB |
| 27 | Level switches | Siemens, Endress & Hauser, Switzer, SBEM |
| 28 | Intelligent MCC/VFD | ABB, Schneider, SIEMENS, Rockwell |

MANAGING DIRECTOR

CG State MFP (T& D) Co-op Federation Ltd. Raipur

SECTION-VI

TECHNICAL BID FORMAT

(Form - 1)

Subject: - Supply, Installation, Testing, Commissioning, Integration and Training of various processing machines as per enclosed specification in **Section-V (Technical Specification)** at Incubation Center Deobhog, District-Gariyaband (C.G.)

| | | |
|---|---|--|
| Tender Notification Number: Fed/Processing Machines/2023-24/III, Dated: 13.12.2023 | | |
| Date of opening of Tender | | Round 1:12.01.2024 Round 2: 02.02.2024 Round 3: 13.02.2024 |
| 1. | Status of Bidder (Select) | INDIVIDUAL, PROPRIETORSHIP FIRM, PARTNERSHIP FIRM, COMPANY, HUF, OTHERS) |
| 2. | (a) Proprietor's Name (In case of Proprietorship Firm) / Name of Karta (In case of H) | |
| | (b) Father's Name / Husband's Name | |
| 3. | Address for Correspondence | |
| | (a) House No. | |
| | (b) Street / Location | |
| | (c) Area / Landmark | |
| | (d) City | |
| | (e) District Name | |
| | (f) State | Selection from Drop down menu (List provided by Federation) |
| | (g) Pin Code | |
| 4. | Contact No. 1 (Provide STD Code also in case of Landline No.) | |
| 5. | Alternate Contact Nos. (Mobile No.) | |
| | (a) Contact No. 2 | |
| | (b) Contact No. 3 | |
| 6. | Fax No. (Provide STD Code also) | |
| 7. | Alternate E-mail Id | Should be valid E-mail Id |
| 8. | Income Tax P.A.N. (Scan Copy to be uploaded) | |

| 9. | Goods and Services Tax Identification Number (GSTIN) (Copy of certificate of <u>Goods and Services Tax Identification Number</u> to be uploaded) | | | | | | | | | | | | | | |
|---|---|--|--|---------------------|--|---|------------------------------|---------------------|-------------------------------------|---------|--|---|--|--|--|
| 10. | Financial capacity i.e., The minimum Average Annual Turnover during previous three of the previous five financial years as per Turnover Certificate (as per clause ref 15.2 of the tender notice)/ (Scanned Copy of CA certificate Turnover certificate having UDIN to be uploaded) <table border="1" style="margin-left: auto; margin-right: auto;"> <thead> <tr> <th>Financial Year</th> <th>Turnover in Rs.</th> </tr> </thead> <tbody> <tr> <td>2020-21</td> <td></td> </tr> <tr> <td>2021-22</td> <td></td> </tr> <tr> <td>2022-23</td> <td></td> </tr> <tr> <td>Average Annual turnover for previous three Financial Year</td> <td></td> </tr> </tbody> </table> | | | Financial Year | Turnover in Rs. | 2020-21 | | 2021-22 | | 2022-23 | | Average Annual turnover for previous three Financial Year | | | |
| Financial Year | Turnover in Rs. | | | | | | | | | | | | | | |
| 2020-21 | | | | | | | | | | | | | | | |
| 2021-22 | | | | | | | | | | | | | | | |
| 2022-23 | | | | | | | | | | | | | | | |
| Average Annual turnover for previous three Financial Year | | | | | | | | | | | | | | | |
| 11. | Registered Address of the office of the bidder & Locations of the manufacturing unit(s) of Processing Machines in the proprietorship of the bidder. | | | | | | | | | | | | | | |
| | (a) | Registered Address of the office of the bidder | | | | | | | | | | | | | |
| | (b) | Complete addresses of all the manufacturing units (if Applicable) of the Processing Machines | | | | | | | | | | | | | |
| 12. | Bidder's Bank Details for Transactions by Federation | | | | | | | | | | | | | | |
| | (a) | Type of Account | Drop Down Menu (Saving Bank A/c / Current A/c / Cash Credit A/c / Overdraft A/c) | | | | | | | | | | | | |
| | (b) | Account Number | | | | | | | | | | | | | |
| | (c) | Name of Bank and Branch | | | | | | | | | | | | | |
| | (d) | IFSC Code | | | | | | | | | | | | | |
| 13. | Documents to support the bidder being Manufacturer/ Authorised dealer/Project Integrator {Scanned copies of document must be uploaded as per clause 15.1 (i) and (iii)} <table border="1" style="margin-left: auto; margin-right: auto;"> <thead> <tr> <th>S. No.</th> <th>Mention whether bidder is Manufacturer/ Authorised Dealer/Project integrator</th> <th>Details of relevant supporting document for below</th> <th>Document enclosed (Yes / No)</th> <th>Document Issue Date</th> <th>Production Capacity (If Applicable)</th> </tr> </thead> <tbody> <tr> <td>1.</td> <td></td> <td></td> <td></td> <td></td> <td></td> </tr> </tbody> </table> | | | S. No. | Mention whether bidder is Manufacturer/ Authorised Dealer/Project integrator | Details of relevant supporting document for below | Document enclosed (Yes / No) | Document Issue Date | Production Capacity (If Applicable) | 1. | | | | | |
| S. No. | Mention whether bidder is Manufacturer/ Authorised Dealer/Project integrator | Details of relevant supporting document for below | Document enclosed (Yes / No) | Document Issue Date | Production Capacity (If Applicable) | | | | | | | | | | |
| 1. | | | | | | | | | | | | | | | |

| | | | | | |
|------------|---|---|--------------------------|--------------------------|--------------------------|
| 14. | The Bidder should have supplied, installed, and commissioned similar machine(s)/ equipment (i.e., supply, installation, Testing and Commissioning of food processing/agro processing/oil extraction/food grain milling/fruit products/juice extraction/herbal extraction plant/ lac processing unit) for the Govt./PSU/Company/ Partnership Firm/Proprietorship/LLP etc., with minimum value of work of INR 50 lakh (scanned copy of required documents as per clause 15.1 subclause (ii),to be uploaded) | | | | |
| | S.No. | Details of similar Machines/ equipment supplied with Purchaser reference | 2020-21 (In Lakh) | 2021-22 (In Lakh) | 2022-23 (In Lakh) |
| | 1. | | | | |
| 14. | Name of the person signing the tender | | | | |
| 15. | Capacity in which the person is signing the tender. | | | | |

I / We hereby submit Technical Tender for Supply, Installation, Testing, Commissioning, Integration and Training of following processing machines at Incubation Center Deobhog, District-Gariyaband (C.G.). The Terms & Conditions of the Tender are acceptable to me / us.

| Code | Processing Unit | Code | Processing Unit |
|------|---|------|--------------------|
| 101 | Chironjee Processing | 104 | Primary Processing |
| 102 | Neem/Mahua/Kusum/Groundnut Oil Processing and Chikki Making | 105 | Lac Processing |
| 103 | Masala Processing | 106 | Pulse Milling |

Signature

Cost of Tender and EMD Details

(Form – 2)

Cost of Tender and, EMD for the Machinery as per Table-2, of tender notice and

| S. No. | Particular* | EMD Plus Cost of Tender (In Rs.) |
|--------|--|----------------------------------|
| 101 | Chironjee Processing Unit Machine | 3,03,540/- |
| 102 | Neem/Mahua/Kusum/Groundnut Oil Processing and Chikki Making Unit | |
| 103 | Masala Processing Unit | |
| 104 | Primary Processing Unit | |
| 105 | Lac Processing Unit | |
| 106 | Pulse Milling Unit | |

*The Bidder will have to make the online payment in combined mode only (Cost of Tender Document and EMD amount i.e., Rs 3540+ Rs 3,00,000 = Rs. 3,03,540). Cost of Tender Document is not refundable. If Bidder fails to meet the eligibility criteria (Technical or Financial) in that case the EMD Cost of Rs. 3,00,000/- only will be refunded).

Undertaking and Letter of Acceptance

(To be given in 100 Rs. Non-Judicial Stamp Paper and uploaded online)

(Form – 3)

Date:

To

Sub: Acceptance of undertaking. Tender NIT No. _____

Name of Tender/Work:

Dear Sir,

1. I / We undertake to abide by the terms & conditions of tender notice along with Annexures.
2. I / We undertake to make the entire supply as per delivery schedule of tender notice.
I / We undertake to make the "Supply, Installation, Testing, Commissioning, Integration and Training of following processing machines at Incubation Center Deobhog, District-Gariyaband (C.G.) as per the technical specifications provided in Section-V of the tender document.

| Code | Processing Unit | Code | Processing Unit |
|------|---|------|--------------------|
| 101 | Chironjee Processing | 104 | Primary Processing |
| 102 | Neem/Mahua/Kusum/Groundnut Oil Processing and Chikki Making | 105 | Lac Processing |
| 103 | Masala Processing | 106 | Pulse Milling |

3. In the event of tender being accepted, we agree to furnish balance Security Deposit within twelve days of dispatch of acceptance of the tender / offer.
4. I / we am / are not blacklisted or otherwise debarred from tendering / supplying from any State or Central Govt. Department / Agency / Undertaking.
5. I / We undertake to supply the required machines as per the specifications provided Section-V of the Tender document.

In case any provision of this tender is found to be violated, Department/organization shall without prejudice to any other right or remedy, reject this tender/bid including forfeiture of the Earnest Money Deposit

Yours faithfully

(Signature of the Bidder, with Official Seal)

TECHNICAL CAPACITY

Details of Experience of Work Completion

(Clause reference 15.1 (ii))

(FORM - 4)

The Bidder should have supplied, installed, and commissioned similar machine(s)/ equipment (i.e., supply, installation, Testing and Commissioning of food processing/agro processing/oil extraction/food grain milling/fruit products/juice extraction/herbal extraction plant/ lac processing unit) for the Govt./PSU/Company/ Partnership Firm/Proprietorship/LLP etc., with minimum value of work of INR 50 lakh during the last three years through a single contract or multiple contracts.

| S.No | Work order no and Date | Contract Value (INR) | Name & Address of the client | Start and completion date of work | Workorder/purchase/supply and commissioning certificate issued from the client Submitted (YES/NO) |
|------|------------------------|----------------------|------------------------------|-----------------------------------|---|
| | | | | | |
| | | | | | |
| | | | | | |
| | | | | | |
| | | | | | |
| | | | | | |
| | | | | | |
| | | | | | |

Mandatory Enclosure: Workorder/purchase/supply and commissioning certificate issued from the client (Govt./PSU/Company/ Partnership Firm/Proprietorship/LLP etc.) to be Uploaded by the Bidder in a single PDF in the same order as mentioned in above table.

Authorized Signatory [In full and initials]

Name and Title of Signatory Date Name and address of the firm

Documents to be uploaded. (Form – 5)

| | |
|-----|---|
| 1. | Scanned copy of PAN Card (Mandatory) |
| 2. | Scanned copy of Aadhaar Card of Managing Director of the Company and in case of Partnership firm Aadhaar Card of at least two of Partners required, in case of Hindu Undivided Family (HUF) Aadhaar Card of Karta and one adult family member is to be enclosed (Mandatory) |
| 3. | Scanned copy of certificate of Goods and Services Tax Identification Number (GSTIN) (Mandatory) |
| 4. | Scanned copy of Partnership Deed (if applicable) |
| 5. | Scanned copy of Certificate of Company Incorporation and List of Latest Directors of Company (if applicable) |
| 6. | Scanned copy of Power of Attorney (if applicable) |
| 7. | Scanned copy of list of family members in case of H.U.F. (if applicable) |
| 8. | Scanned copy of the relevant documents to support the bidder being Manufacturer /Authorised Dealer/ Project Integrator, as per Clause 15.1 (i) of the tender notice (Mandatory) |
| 9. | Undertaking and letter of Acceptance as per FORM 3 (To be given in 100 Rs. Non-Judicial Stamp Paper (Mandatory) |
| 10. | Form 4 along with required supporting documents to be uploaded as a single PDF: Technical Capacity (FORM 4) to be uploaded along with Scanned copy of the relevant documents in support of supply, installation, and commissioning of similar equipment (i.e., supply / installation of food processing/agro processing/oil extraction/food grain milling/fruit products/juice extraction/herbal extraction plant/ Lac processing unit) during last three years (Condition 15.1(ii) of the tender notice) (Mandatory) |
| 11. | CA certified Turnover Certificate (having UDIN) of the Bidder of the previous three years 2020-21, 2021-22 & 2022-23, which satisfies the condition as per clause 15.2 of the Tender Notice (Mandatory) |
| 12. | Scanned Copy of income tax return for FY 2020-21(Mandatory) |
| 13. | Scanned Copy of income tax return for FY 2021-22(Mandatory) |
| 14. | Scanned Copy of income tax return for FY 2022-23(Mandatory) |
| 15. | CA certified certificate(having UDIN) Balance Sheet and profit and loss account of the Bidder for the financial year 2020-21 clause 15.2 (Mandatory) |
| 16. | CA certified certificate(having UDIN) Balance Sheet and profit and loss account of the Bidder for the financial year 2021-22 clause 15.2 (Mandatory) |
| 17. | CA certified certificate(having UDIN) Balance Sheet and profit and loss account of the Bidder for the financial year 2022-23 clause 15.2 (Mandatory) |
| 18. | Self-Declaration of Non-Black List as per clause 15.1(iv) |
| 19. | Form 6 on the bidder's letter head as per clause 15.1 (iii) |
| 20. | Form 7 on the letter head of company/ Authorised Dealer/Manufacturer as per clause 15.1 (iii) |
| 21. | Any other relevant Document |
| 22. | Technical Specifications of Machinery to be supplied (documents to be attached separately) |
| 23. | Coloured Scanned Document of machine's brochure with complete specifications along with machine photographs. |

| | |
|------------|--------------------------------------|
| 24. | Other Technical Information, if any. |
|------------|--------------------------------------|

Note: All the document needs to be sign and seal by the bidders

Form – 6

(To be submitted on the letterhead of the bidding company/firm)
Reference clause 15.1(iii)

The bidder needs to fill the details against each of the listed Machines for which the bidding firm is Manufacturer/Authorised Dealer / Project Integrator for this Tender notice.

| Code | Machine for Processing Units | Bidder– as Project Integrator with Company/ Authorised Dealer/Manufacturer |
|------|--|--|
| 101 | Chironjee Processing | |
| 102 | Neem/Mahua/Kusum/Groundnut Oil Processing and Chikki Making- | |
| 103 | Masala Processing | |
| 104 | Primary Processing | |
| 105 | Lac Processing | |
| 106 | Pulse Milling | |

Authorized Signatory [In full and initials]

Name and Title of Signatory Date Name and address of the firm

Letter of Authorization

<To be submitted on the letterhead of the Manufacturer/Authorised dealer>

Form – 7

To,

The Managing Director (MD)
C.G State Minor Forest Produce Fed.
Van Dhan Bhawan, Sector -24,
Atal Nagar Nava Raipur,
Chhattisgarh
Phone +91 - 91 771 2513100
E-mail: mfpfed.cg@nic.in

Subject: Letter of authorisation for supply of processing machine for the tender issued by CGMFPFED for Supply, Installation, Testing, Commissioning, Integration and Training of following processing machines at Incubation Center Deobhog, District-Gariyaband (C.G.)

Reference: **Tender Notification No. Fed/Processing Machines/2023-24/III, Dated:13.12.23**

Dear Sir/Madam

1. M/s _____ manufacturer/authorised dealer for the machines used for food processing/agro processing/oil extraction/food grain milling/fruit products/juice extraction/herbal extraction plant/ Lac processing unit, are pleased to associate with M/s _____ (**name of the bidding firm**) for supply of machines mentioned in table below against the tender issued by CGMFPFED vide Notification No. Fed/Processing Machines/2023-24/III, Dated:13.12.23, for Supply, Installation, Testing, Commissioning, Integration and Training of following processing machines at Incubation Center Deobhog, District-Gariyaband (C.G.).

| Code | Machine for Processing Units |
|------|------------------------------|
| | |
| | |
| | |
| | |

2. We would be responsible to supply above mentioned machines to _____ (**Name of the bidder**) as per the specification set forth in the Section V "Technical Specification" of the Tender document.

Enclosure: Credentials and supporting documents of Authorised Dealer/ Manufacturer as per 15.1 (i)

Signature and stamp

Designation

SECTION-VII

FINANCIAL BID FORMAT

(Form - 1)

Tender Notification Number: **Fed/Processing Machines/2023-24/III Dated: 13.12.2023.**
 Date of opening of Tender Round 1: 12.01.2024
Round 2: 02.02.2024
Round 3: 13.02.2024

1. I / We submit financial tender for the **“Supply, Installation, Testing, Commissioning, Integration and Training of following processing machines at Incubation Center Deobhog, District-Gariyaband (C.G.)”** as per terms & conditions of tender notice of Chhattisgarh State Minor Forest Produce (Trading & Development) Co-operative Federation Limited, Raipur which are acceptable to me/us.

| Code | Processing Unit | Code | Processing Unit |
|------|---|------|--------------------|
| 101 | Chironjee Processing | 104 | Primary Processing |
| 102 | Neem/Mahua/Kusum/Groundnut Oil Processing and Chikki Making | 105 | Lac Processing |
| 103 | Masala Processing | 106 | Pulse Milling |

RATE QUOTED ARE INCLUSIVE OF MACHINES AND SERVICES TAX (GST) INCLUDING LOCAL BODIES TAXES (IF APPLICABLE FROM THE POINT OF DESPATCH, INSURANCE, FREIGHT FROM DESPATCHING POINT TO SPECIFIED DESTINATION IN CHHATTISGARH AND ANY OTHERS) FOR DELIVERY AT DEOBHOG. RATES SHOULD ALSO INCLUDE TRAINING CHARGES FOR THE PERIOD OF SIX MONTHS STARTING FROM THE DATE OF COMPLETION OF TRIAL RUN AND ACCESSORIES.

A) Cost of Processing Machine

| S.no | Description of Processing | Specification and Quantity | Cost of Processing Machines including GST (In INR) |
|------|---|----------------------------|--|
| 101 | Chironjee Processing | As mentioned in Section-V | |
| 102 | Neem/Mahua/Kusum/Groundnut Oil Processing and Chikki Making | | |
| 103 | Masala Processing | | |
| 104 | Primary Processing | | |
| 105 | Lac Processing | | |
| 106 | Pulse Milling | | |
| | Total Amount (INR) | | |

95 % Weightage on Total amount provided under A) Cost of Processing Machine for the purpose of evaluation.

| | |
|---|---|
| B) Engagement of Technical Human Resource(s) from the Bidders | |
| Description of Work | Cost per Manmonth inclusive of GST (INR) |
| Providing Technical Human Resource for O&M/ Training/Skill Development of staff engaged in the processing units as per requirement | |
| Estimated requirement of Technical Resource- 48 Manmonth with the duration of 12 months after completion of Trial run and vendors contractual obligation for mandatory training as per Section III – “Special Condition of Contract” reference clause 31.1 of the tender document | |
| 5 % Weightage on B) Engagement of Technical Human Resource(s) for the purpose of evaluation | |

Note:

- I. For the above-mentioned machines, all the relevant materials shall be provided by the bidder for installation of the plant at each destination.
- II. **A) Cost of Processing Machine-** The above-mentioned machines must be delivered and installed at the destination. Skill enhancement and Hands-on training for the operation and handling of machines of each unit must be provided by bidder for the period of 6 months starting from the date of completion of trial run. The cost shall inclusive of above with all taxes.
- III. **B) Engagement of Technical Human Resource(s)** - This service will be availed based on the requirement of Federation after the completion of Trial run and vendors contractual obligation for mandatory training as per **Section III-“Special Condition of Contract”** reference clause 31.1 of the tender document. The payment for the services if availed by Federation under this shall be made on monthly basis upon submission of monthly invoice and attendance records.

I / We hereby submit financial tender for “Supply, Installation, Testing, Commissioning, Integration and Training of following processing machines at Incubation Center Deobhog, District-Gariyaband (C.G.)” as per terms & conditions of the above-mentioned notification of Chhattisgarh State Minor Forest Produce (Trading & Development) Co-operative Federation Limited., Raipur which are acceptable to me / us. I / We are aware that while evaluating the tender, if any, of the items mentioned above is not found meeting the requirement of the tender notice, the tender will not be accepted.

| Code | Processing Unit | Code | Processing Unit |
|------|---|------|--------------------|
| 101 | Chironjee Processing | 104 | Primary Processing |
| 102 | Neem/Mahua/Kusum/Groundnut Oil Processing and Chikki Making | 105 | Lac Processing |
| 103 | Masala Processing | 106 | Pulse Milling |

S

SECTION-VIII: APPROPRIATE LAYOUT OF PROCESSING UNITS

101 CHIRONJEE PROCESSING UNIT

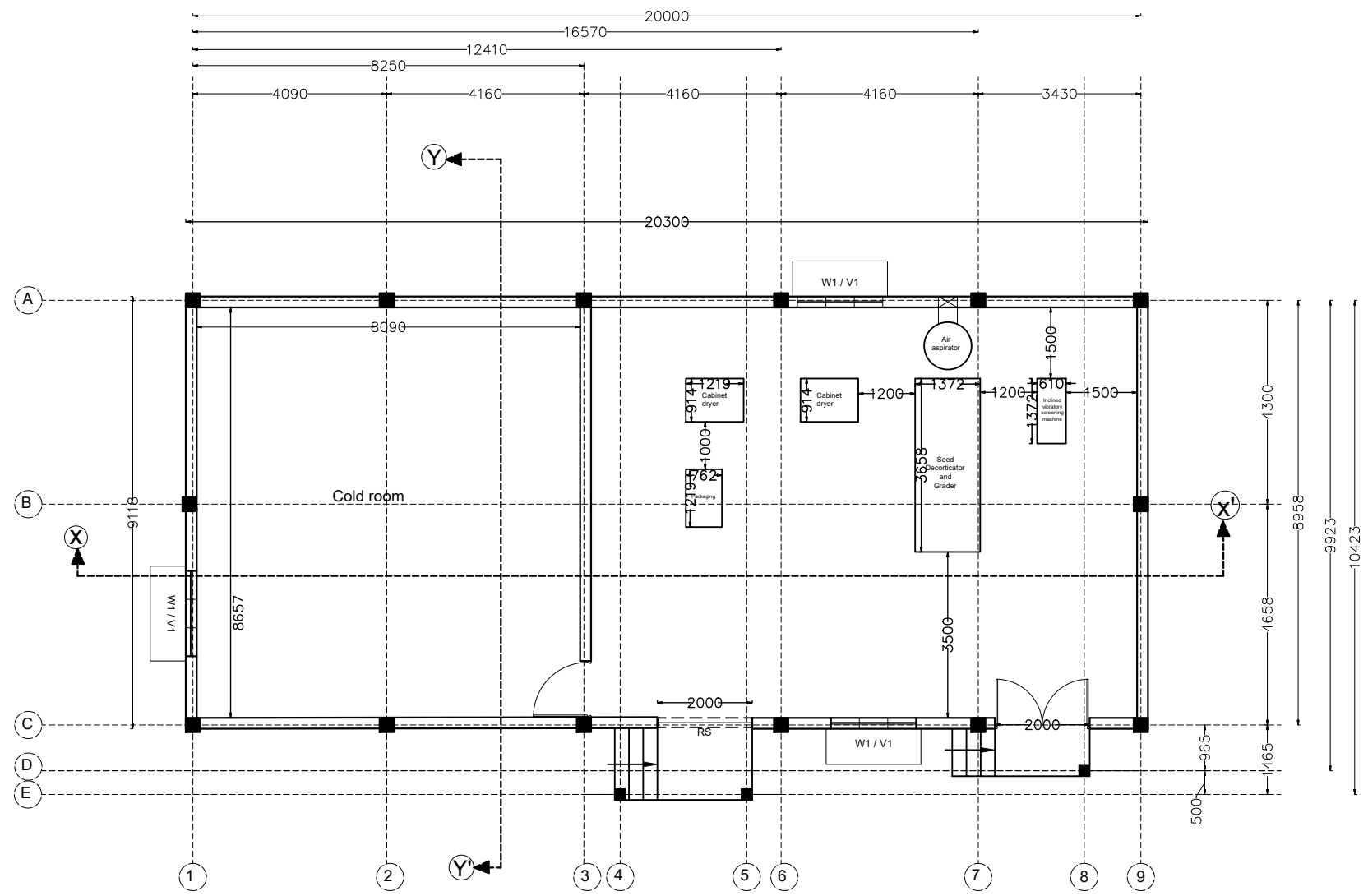

CHIRONJEE PROCESSING UNIT
BUILD UP AREA - 192 SQM

LIST OF DRAWING
CHIRONJEE PROCESSING UNIT
DP0001 DRG CL 01 100

- 1 - PLAN LAYOUT
- 2 - SECTION / ELEVATION
- 3 - COLUMN LAYOUT
- 4 - FOOTING LAYOUT
- 5 - GROUND BEAM LAYOUT
- 6 - BEAM LAYOUT (2.5 M ABOVE)
- 7 - BEAM LAYOUT (4.5 M ABOVE)
- 8 - TRUSS DETAIL
- 9 - ELECTRICAL LAYOUT

| OPENING SCHEDULE | | | |
|------------------|---------|---------|-------------|
| NAME | | SAYMBOL | |
| WINDOW | | W1 | |
| VENTILATOR | | V1 | |
| ROLLING SHUTTER | | R1 | |
| DOOR | | D1 | |
| SN | SAYMBOL | NOS | SIZE |
| 01 | W1 | 02 | 1.8M X 1.5M |
| 02 | V1 | 03 | 1.8 M X 1 M |
| 03 | R1 | 01 | 2M X 2.4 M |
| 04 | D2 | 01 | 2M X 2.1M |

| | | | | | | | |
|--|-------------|---------------------|-----------|------------|--|---|--|
| DRG NO: DP0001 DRG CL 01 100/01 | | SHEET NO: 1 OF 9 | | REV. R0 | SCALE: NTS | SWATI Architecture landscape interior ARCHITECTS PLANERS ENGINEERING INTERIOR DESIGN 282 , tulip , A block , Talpuri International colony , Bhilai , C.G. Email - swati.arch@outlook.com | |
| DESIGNED: | DRAWN: | CHECKED: | VERIFIED: | APPROVED: | CLIENT: | | |
| UPENDRA SINGH | SIMRAN SONI | UPENDRA SINGH | ADMIN | ADMIN | CHHATTISGARH STATE MINOR FOREST PRODUCE | | |
| ISSUED FOR: | | | UNIT: | DATE: | PROJECT: | | |
| GOOD FOR CONSTRUCTION | | | MILIMETER | 12.05.2022 | INCUBATION CENTER & RURAL INDUSTRIAL PARK DEOBHOG GARIYABAND C.G. | | |
| This drawing is the property of HUP DESIGN and is to be used only for the purpose for which it was lent and must not be in any way detrimental to the interest of the company and is subject to return on demand | | | | | TITLE: | | |
| | | | | | CHIRONJEE PROCESSING UNIT PLAN LAYOUT | | |

102 NEEM / MAHUA / KUSUM /GROUNDNUT OIL/ CHIKKI MAKING UNIT

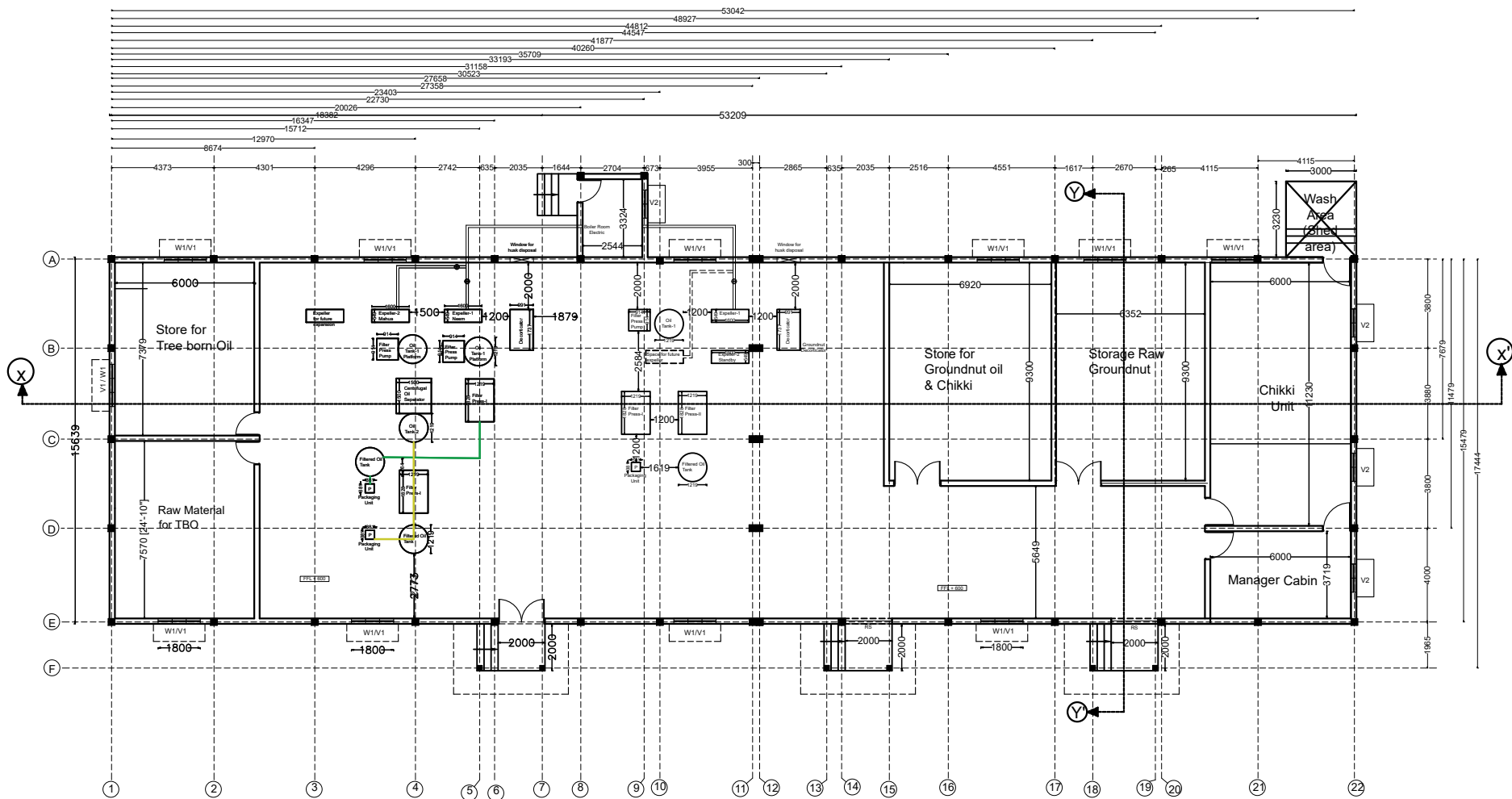

NEEM / MAHUA / KUSUM /GROUNDNUT OIL/ CHIKKI UNIT
BUILD UP AREA - 866 SQM

| | | | |
|--|---------|---------|---------------|
| LIST OF DRAWING NEEM / MAHUA / KUSUM / GROUND NUT OIL EXTRACTION DP0001 DRG CL 01 101 | | | |
| 1 - PLAN LAYOUT | | | |
| 2 - SECTION / ELEVATION | | | |
| 3 - COLUMN LAYOUT | | | |
| 4 - FOOTING LAYOUT | | | |
| 5 - GROUND BEAM LAYOUT | | | |
| 6 - BEAM LAYOUT (2.5 M ABOVE) | | | |
| 7 - BEAM LAYOUT (4.5 M ABOVE) | | | |
| 8 - TRUSS DETAIL | | | |
| 9 - ELECTRICAL LAYOUT | | | |
| OPENING SCHEDULE | | | |
| NAME | | SAYMBOL | |
| WINDOW | | W1 | |
| VENTILATOR | | V1 | |
| ROLLING SHUTTER | | R1 | |
| DOOR | | D1 | |
| SN | SAYMBOL | NOS | SIZE |
| 01 | W1 | 11 | 1.8M X 1.5M |
| 02 | V1 | 15 | 1.8 M X 1 M |
| 03 | D2 | 03 | 1.2 M X 2.1M |
| 04 | D1 | 07 | 1M X 2.1 M |
| 05 | R1 | 02 | 2.0 M X 2.5 M |

| | | | | | | | | | | |
|--|--|--------------------|--|------------------------|-----------------|----------|------------------|---|--|--|
| DRG NO: DP0001 DRG CL 01 101/01 1 OF 9 | | | | | SHEET NO: R0 | REV. NTS | SCALE: NTS | SWATI Architecture landscape interior ARCHITECTS PLANERS ENGINEERING INTERIOR DESIGN 282 , tulip , A block , Talpuri International colony , Bhilai , C.G. Email - swati.arch@outlook.com | | |
| DESIGNED: UPENDRA SINGH | | DRAWN: SIMRAN SONI | | CHECKED: UPENDRA SINGH | VERIFIED: ADMIN | | APPROVED: ADMIN | | CLIENT: CHHATTISGARH STATE MINOR FOREST PRODUSE | |
| ISSUED FOR: GOOD FOR CONSTRUCTION | | | | | UNIT: MILIMETER | | DATE: 12.05.2022 | | PROJECT: INCUBATION CENTER & RURAL INDUSTRIAL PARK DEOBHOG GARIYABAND C.G. | |
| This drawing is the property of HUP DESIGN and is to be used only for the purpose for which it was lent and must not be in any way detrimental to the interest of the company and is subject to return on demand | | | | | | | | TITLE: NEEM / MAHUA / KUSUM /GROUNDNUT OIL EXTRACTION UNIT PLAN LAYOUT | | |

103 MASALA PROCESSING UNIT

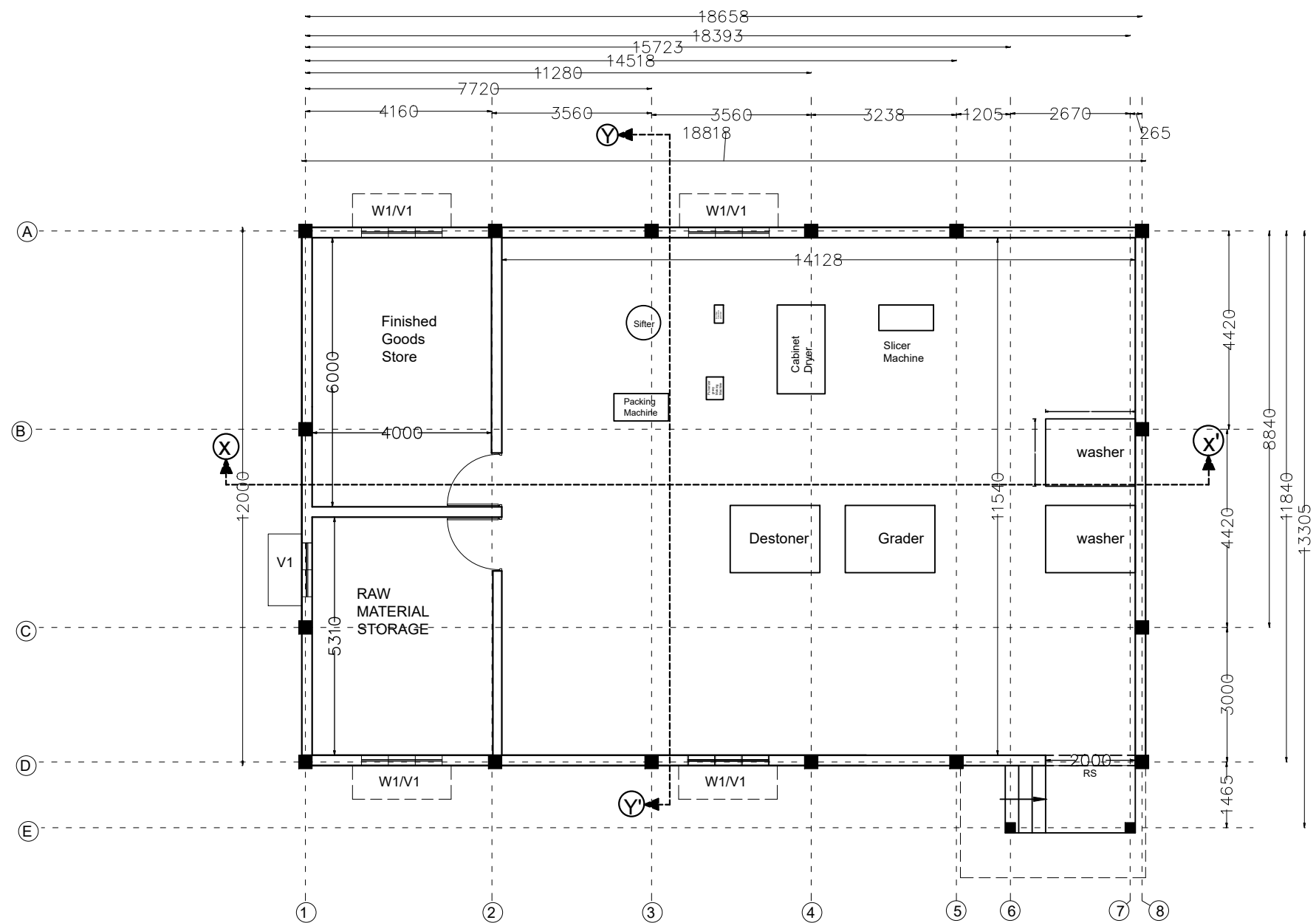

MASALA PROCESSING UNIT
BUILD UP AREA - 230 SQM

LIST OF DRAWING
MASALA PROCESSING UNIT
DP0001 DRG CL 01 102

- 1 - PLAN LAYOUT
- 2 - SECTION / ELEVATION
- 3 - COLUMN LAYOUT
- 4 - FOOTING LAYOUT
- 5 - GROUND BEAM LAYOUT
- 6 - BEAM LAYOUT (2.5 M ABOVE)
- 7 - BEAM LAYOUT (4.5 M ABOVE)
- 8 - TRUSS DETAIL
- 9 - ELECTRICAL LAYOUT

| OPENING SCHEDULE | | | |
|------------------|---------|-----|-------------|
| NAME | | | SAYMBOL |
| WINDOW | | | W1 |
| VENTILATOR | | | V1 |
| ROLLING SHUTTER | | | R1 |
| DOOR | | | D1 |
| SN | SAYMBOL | NOS | SIZE |
| 01 | W1 | 04 | 1.8M X 1.5M |
| 02 | V1 | 05 | 1.8 M X 1 M |
| 03 | D1 | 02 | 1 M X 2.1M |
| 04 | R1 | 01 | 2M X 2.1 M |

| | | | | | | | | | | | |
|--|--|--------------------|--|------------------------|--|------------------|--|--|--|---|--|
| DRG NO: DP0001 DRG CL 01 102/01 1 OF 9 | | | | SHEET NO: 1 OF 9 | | REV. R0 | | SCALE: NTS | | <div>SWATI Architecture landscape interior</div> <div>ARCHITECTS PLANERS ENGINEERING INTERIOR DESIGN</div> <div>282 , tulip , A block , Talpuri International colony , Bhilai , C.G. Email - swati.arch@outlook.com</div> | |
| DESIGNED: UPENDRA SINGH | | DRAWN: SIMRAN SONI | | CHECKED: UPENDRA SINGH | | VERIFIED: ADMIN | | APPROVED: ADMIN | | CLIENT: CHHATTISGARH STATE MINOR FOREST PRODUSE | |
| ISSUED FOR: GOOD FOR CONSTRUCTION | | | | UNIT: MILIMETER | | DATE: 12.05.2022 | | PROJECT: INCUBATION CENTER & RURAL INDUSTRIAL PARK DEOBHOG GARIYABAND C.G. | | TITLE: MASALA PROCESSING UNIT PLAN LAYOUT | |
| This drawing is the property of HUP DESIGN and is to be used only for the purpose for which it was lent and must not be in any way detrimental to the interest of the company and is subject to return on demand | | | | | | | | | | | |

104 PRIMARY PROCESSING UNIT

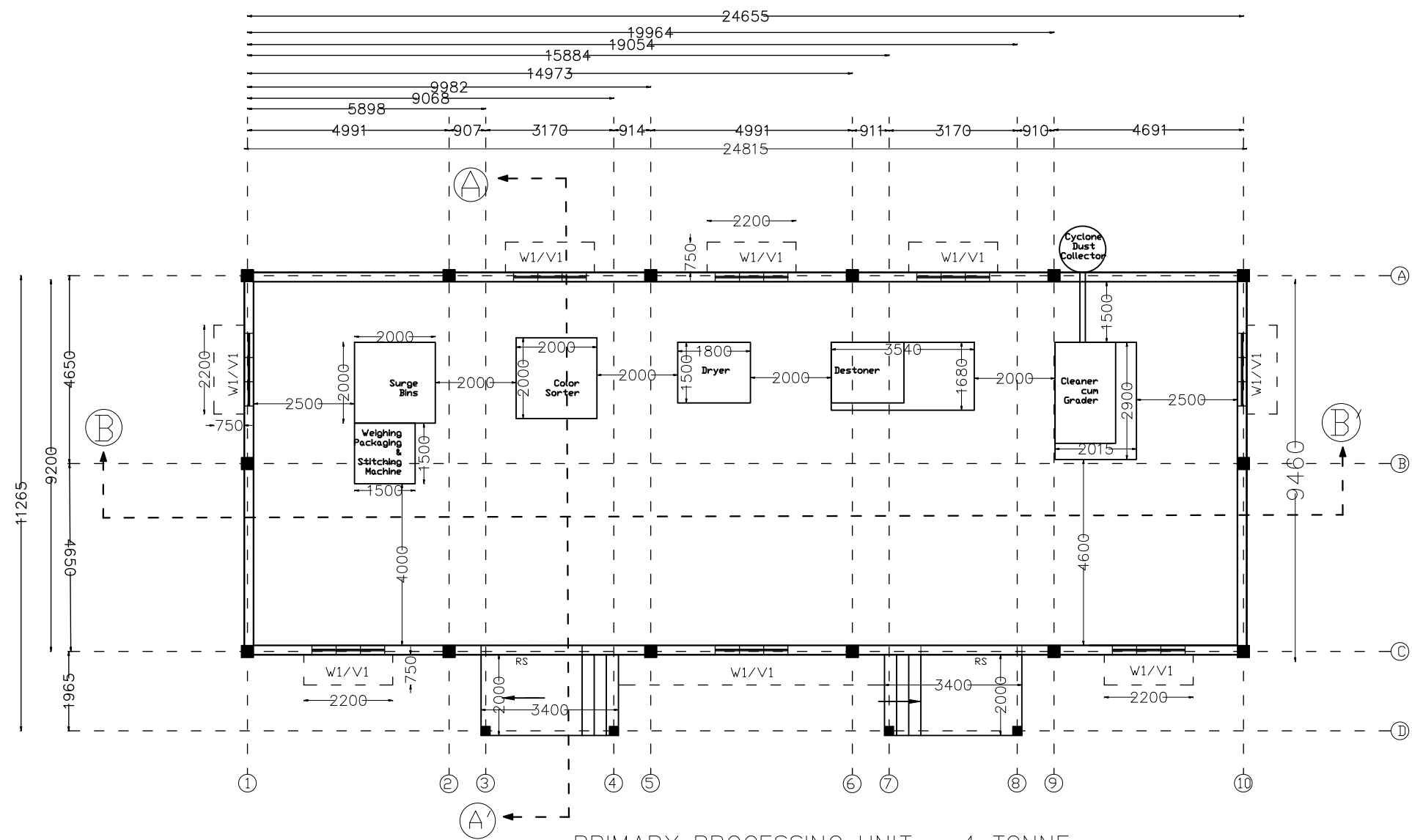

PRIMARY PROCESSING UNIT – 4 TONNE
BUILTUP AREA – 235 SQM

| LIST OF DRAWING | | | |
|---------------------------------|---------|-----|--------------|
| PRIMARY PROCESSING UNIT | | | |
| DP0001 DRG CL 01 103 | | | |
| 1 - PLAN LAYOUT | | | |
| 2 - SECTION / ELEVATION | | | |
| 3 - COLUMN LAYOUT | | | |
| 4 - FOOTING LAYOUT | | | |
| 5 - GROUND BEAM LAYOUT | | | |
| 6 - BEAM LAYOUT (2.5 M ABOVE) | | | |
| 7 - BEAM LAYOUT (4.5 M ABOVE) | | | |
| 8 - TRUSS DETAIL | | | |
| 9 - ELECTRICAL LAYOUT | | | |
| OPENING SCHEDULE | | | |
| NAME | | | SAYMBOL |
| WINDOW | | | W1 |
| VENTILATOR | | | V1 |
| ROLLING SHUTTER | | | R1 |
| DOOR | | | D1 |
| SN | SAYMBOL | NOS | SIZE |
| 01 | W1 | 08 | 1.8M X 1.5M |
| 02 | V1 | 08 | 1.8 M X 1 M |
| 03 | R1 | 02 | 2.0M X 2.4 M |

| | | | | | | |
|--|-------------|---------------|-----------|------------|----------|---|
| DRG NO: | | SHEET NO: | | REV. | SCALE: | SWATI Architecture landscape interior ARCHITECTS PLANERS ENGINEERING INTERIOR DESIGN 282 , tulip , A block , Talpuri International colony , Bhilai , C.G. Email - swati.arch@outlook.com |
| DP0001 DRG CL 01 103 / 01 | | 1 OF 9 | | R0 | NTS | |
| DESIGNED: | DRAWN: | CHECKED: | VERIFIED: | APPROVED: | CLIENT: | CHHATTISGARH STATE MINOR FOREST PRODUCE |
| UPENDRA SINGH | SIMRAN SONI | UPENDRA SINGH | ADMIN | ADMIN | | |
| ISSUED FOR: | | | UNIT: | DATE: | PROJECT: | INCUBATION CENTER & RURAL INDUSTRIAL PARK DEOBHOG GARIYABAND C.G. |
| GOOD FOR CONSTRUCTION DRAWING | | | MILIMETER | 12.05.2022 | | |
| This drawing is the property of HUP DESIGN and is to be used only for the purpose for which it was lent and must not be in any way detrimental to the interest of the company and is subject to return on demand | | | | | | TITLE: |
| | | | | | | PRIMARY PROCESSING UNIT PLAN LAYOUT |

105 LAC PROCESSING UNIT

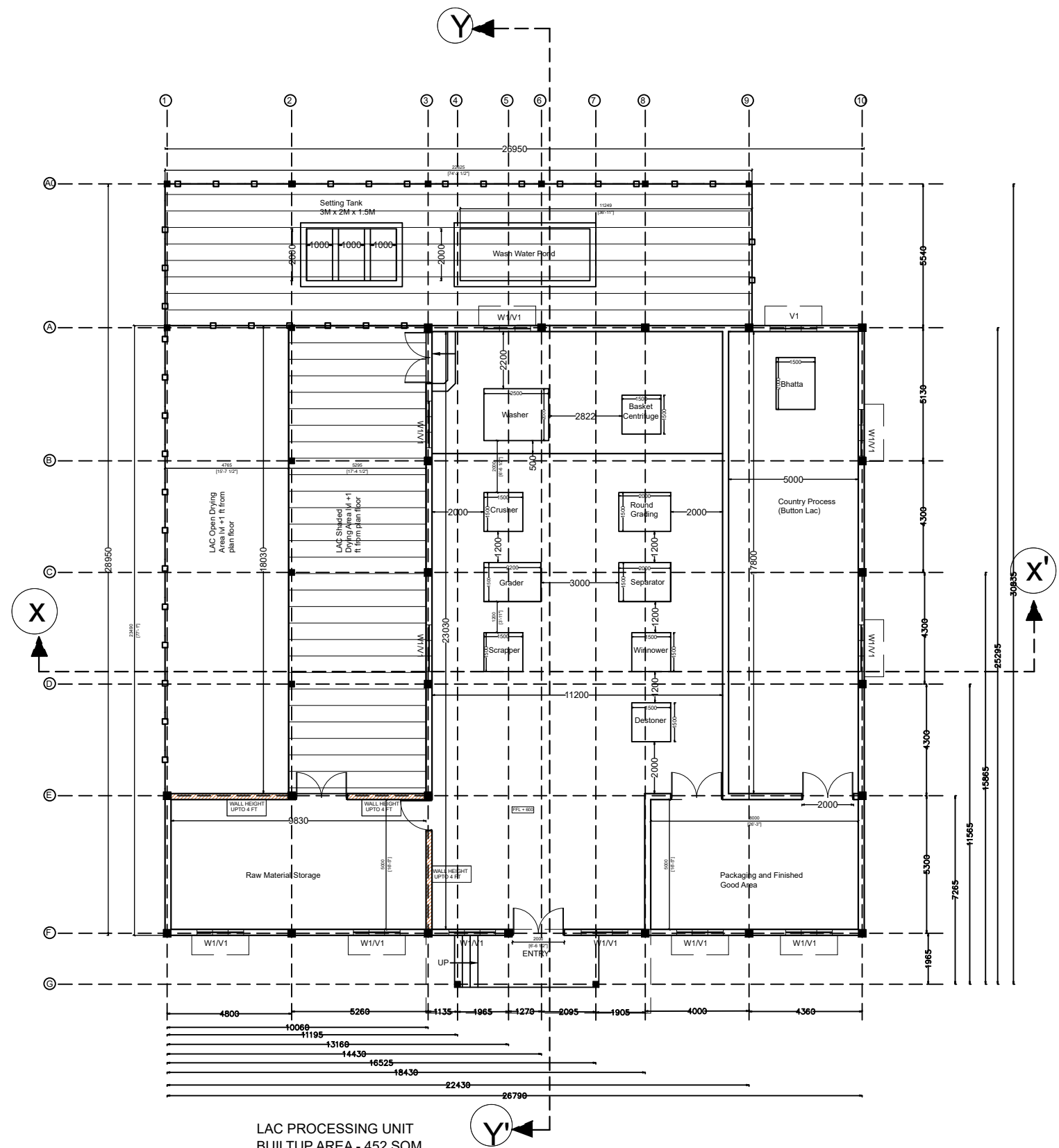

LAC PROCESSING UNIT
BUILTUP AREA - 452 SQM
OPEN DRYING AREA - 90 SQM
SHADED DRYING AREA - 90 SQM
FILTRATION TANK - 15 SQM

| LIST OF DRAWING | | | |
|---------------------------------|---------|---------|-------------|
| LAC PROCESSING UNIT | | | |
| DP0001 DRG CL 01 104 | | | |
| 1 - PLAN LAYOUT | | | |
| 2 - SECTION / ELEVATION | | | |
| 3 - COLUMN LAYOUT | | | |
| 4 - FOOTING LAYOUT | | | |
| 5 - GROUND BEAM LAYOUT | | | |
| 6 - BEAM LAYOUT (2.5 M ABOVE) | | | |
| 7 - BEAM LAYOUT (4.5 M ABOVE) | | | |
| 8 - TRUSS DETAIL | | | |
| 9 - ELECTRICAL LAYOUT | | | |
| OPENING SCHEDULE | | | |
| NAME | | SAYMBOL | |
| WINDOW | | W1 | |
| VENTILATOR | | V1 | |
| ROLLING SHUTTER | | R1 | |
| DOOR | | D1 | |
| SN | SAYMBOL | NOS | SIZE |
| 01 | W1 | 10 | 1.8M X 1.5M |
| 02 | V1 | 10 | 1.8 M X 1 M |
| 03 | D1 | 01 | 1M X 2.1 M |
| 04 | D2 | 05 | 2M X 2.1M |

| | | | | | | | | | | | | | | | | | | | | | | | | |
|--|--|--|-------------|--|------------------|---------------|---------|--|------------|--|---|------------|--|-----------------------------|---------|--|---|----------|--|--|--|--|--|--|
| DRG NO: DP0001 DRG CL 01 104/01 | | | | | SHEET NO: 1 OF 9 | | REV. R0 | | SCALE: NTS | | <div>SWATI Architecture landscape interior</div> <div>ARCHITECTS PLANERS ENGINEERING INTERIOR DESIGN</div> <div>282 , tulip , A block , Talpuri International colony , Bhilai , C.G. Email - swati.arch@outlook.com</div> | | | | | | | | | | | | | |
| DESIGNED: | | | DRAWN: | | | CHECKED: | | | VERIFIED: | | | APPROVED: | | | CLIENT: | | CHHATTISGARH STATE MINOR FOREST PRODUCE | | | | | | | |
| UPENDRA SINGH | | | SIMRAN SONI | | | UPENDRA SINGH | | | ADMIN | | | ADMIN | | | | | | | | | | | | |
| ISSUED FOR: | | | | | | UNIT: | | | | | | DATE: | | | | | | PROJECT: | | INCUBATION CENTER & RURAL INDUSTRIAL PARK DEOBHOG GARIYABAND C.G. | | | | |
| GOOD FOR CONSTRUCTION | | | | | | MILIMETER | | | | | | 12.05.2022 | | | | | | | | | | | | |
| This drawing is the property of HUP DESIGN and is to be used only for the purpose for which it was lent and must not be in any way detrimental to the interest of the company and is subject to return on demand | | | | | | | | | | | | TITLE: | | LAC PROCESSING UNIT PLAN | | | | | | | | | | |
| | | | | | | | | | | | | | | | | | | | | | | | | |

106 PULSE MILLING UNIT

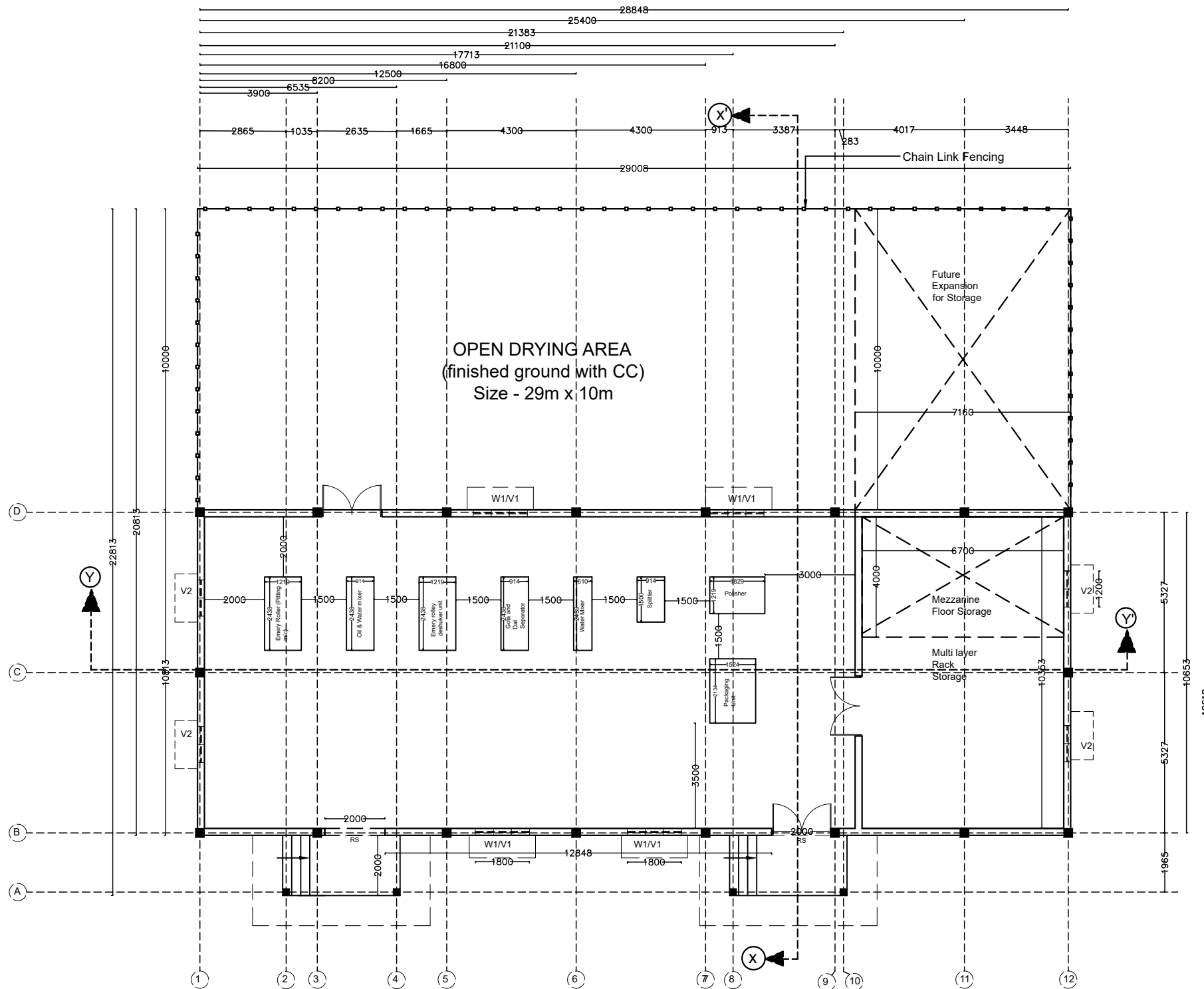

PULSE MILLING UNIT
BUILTUP AREA - 314 SQM
DRYING PLATFORM AREA - 290 SQM

| LIST OF DRAWING | | | |
|---------------------------------|---------|---------|--------------|
| PULSE MILLING UNIT | | | |
| DP0001 DRG CL 01 105 | | | |
| 1 - PLAN LAYOUT | | | |
| 2 - SECTION / ELEVATION | | | |
| 3 - COLUMN LAYOUT | | | |
| 4 - FOOTING LAYOUT | | | |
| 5 - GROUND BEAM LAYOUT | | | |
| 6 - BEAM LAYOUT (2.5 M ABOVE) | | | |
| 7 - BEAM LAYOUT (4.5 M ABOVE) | | | |
| 8 - TRUSS DETAIL | | | |
| 9 - ELECTRICAL LAYOUT | | | |
| OPENING SCHEDULE | | | |
| NAME | | SAYMBOL | |
| WINDOW | | W1 | |
| VENTILATOR | | V1 | |
| ROLLING SHUTTER | | R1 | |
| DOOR | | D1 | |
| SN | SAYMBOL | NOS | SIZE |
| 01 | W1 | 04 | 1.8M X 1.5M |
| 02 | V1 | 08 | 1.8 M X 1 M |
| 03 | D2 | 03 | 2M X 2.1M |
| 04 | R1 | 01 | 2.0M X 2.4 M |

| | | | | | | | | | |
|--|--|--------------------|--|------------------------|------------------|------------------|------------|---|---|
| DRG NO: DP0001 DRG CL 01 105/01 | | | | | SHEET NO: 1 OF 9 | REV. R0 | SCALE: NTS | SWATI Architecture landscape interior ARCHITECTS PLANERS ENGINEERING INTERIOR DESIGN 282 , tulip , A block , Talpuri International colony , Bhilai , C.G. Email - swati.arch@outlook.com | |
| DESIGNED: UPENDRA SINGH | | DRAWN: SIMRAN SONI | | CHECKED: UPENDRA SINGH | VERIFIED: ADMIN | APPROVED: ADMIN | | CLIENT: | CHHATTISGARH STATE MINOR FOREST PRODUCE |
| ISSUED FOR: GOOD FOR CONSTRUCTION | | | | | UNIT: MILIMETER | DATE: 12.05.2022 | | PROJECT: | |
| This drawing is the property of HUP DESIGN and is to be used only for the purpose for which it was lent and must not be in any way detrimental to the interest of the company and is subject to return on demand | | | | | | | | TITLE: | PULSE MILLING UNIT PLAN LAYOUT |